



# ASSEMBLY INSTRUCTIONS AND PARTS LIST

**SR75**  
**(78113A00)**



223 15th St. N.E.  
Sioux Center, IA USA  
51250-2120  
[www.linkmortuaryequipment.com](http://www.linkmortuaryequipment.com)

**QUESTIONS?**  
**CALL CUSTOMER**  
**SERVICE**  
**1-800-248-3057**

The **Link SR75** fits the 2000 to 2014 Chevy Suburban and GMC Yukon XL.

Estimated Weight: 45 lbs.

Link Mortuary Equipment, a division of Link Mfg., Ltd.  
[www.linkmortuaryequipment.com](http://www.linkmortuaryequipment.com)

78113011  
AUG 4, 2023

**IMPORTANT:** IT IS IMPORTANT THAT THE ENTIRE INSTALLATION INSTRUCTIONS BE READ THOROUGHLY BEFORE PROCEEDING WITH THE INSTALLATION.

## 1. INTRODUCTION

Thank you for choosing a Link Mortuary Equipment SR75. We want to help you get the best results from this deck and to operate it safely. This instruction contains information to assist in the installation of the Link Mortuary Equipment SR75. This instruction is intended solely for use with this product.

All information in this instruction is based on the latest information available at the time of printing. Link Manufacturing reserves the right to change its products or manuals at any time without notice.

Damaged components should be returned to Link with a pre-arranged Returned Materials Authorization (RMA) number through the Customer Service Department. The damaged component may then be replaced if in compliance with warranty conditions.

Review the **Parts List** on **Page 3** to become familiar with the different components of the **SR75**. Be sure all items are included before beginning assembly.

**IMPORTANT:** Installation of the **SR75** may vary depending on what type of vehicle you have and how it is set up. Due to variables in different vehicles, the fit of the **SR75** should be evaluated before beginning installation.

- A.** The SR75 is held down using existing fastener holes from the cargo hold-downs. See **Fig. 1** for approximate location. Remove the cargo hold-downs and their fasteners with the supplied Torx key.
- B.** The ramp stop bracket (Item #18) is shipped unattached. See **Fig. 2** for details on attaching it. Remove the two bolts that hold on the ramp mount block (Item # 13), and then attach the bracket and the ramp mount block using the bolts that were just removed. **Note:** There is some adjustment that can be made with the ramp holder bracket on the ramp to properly align the ramp holders.
- C.** Set the spacers (Item #21) in place over the cargo hold-down holes and set the deck in place, aligning the hold-down holes in the deck with the cargo hold-down holes where the bolts were removed in Step A. Loosely install the two button head screws (Item #11). Do not tighten at this time.
- D.** Snap the rear ramp into place and confirm proper fit of the unit. With the deck positioned, check all clearance issues. Leave adequate clearance between the deck/ramp and the vehicle components.
- E.** Once the deck is positioned, tighten the two button head screws with the hex key that is provided. Tighten firmly, but do not over-tighten.

### Maintenance:

- A.** Clean with soap and water or window cleaner.
- B.** To insure the ease of ramp operation, you may lubricate the female ramp holder with silicone. Use lube sparingly.
- C.** Call Link Mfg. 1-800-248-3057 with any questions or comments.

**FIG. 1**



**FIG. 2**

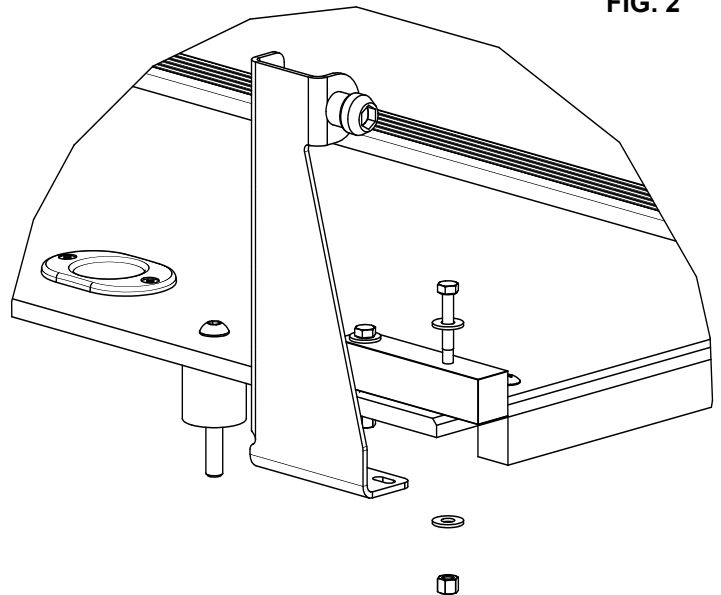

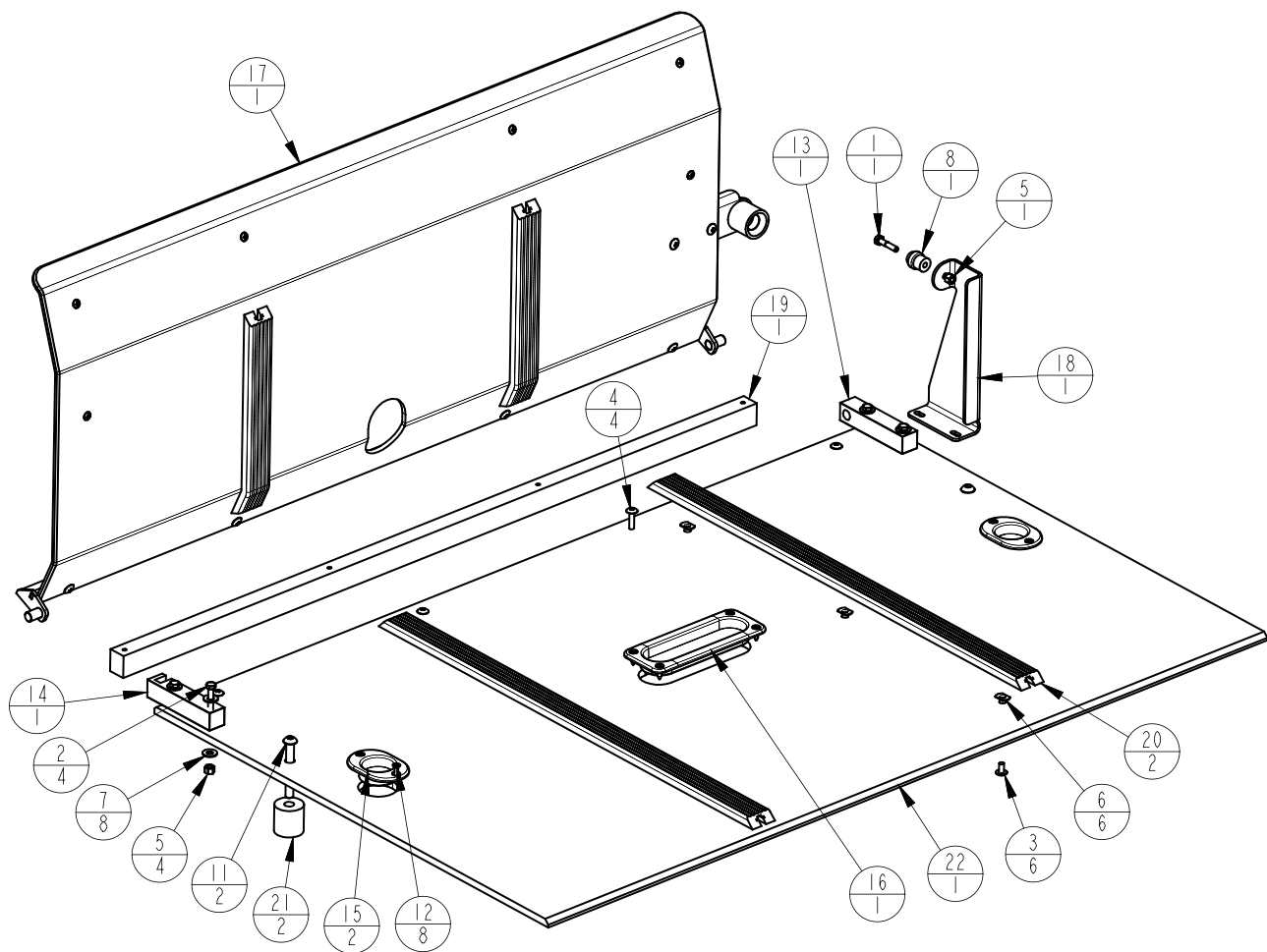

BILL OF MATERIALS FOR ASSEMBLY:			78113A00
ITEM	PART NUMBER	DESCRIPTION	QTY
1	1401-0810	1/4 X 1 1/4 UNC HEX CAP SCR (GR 5)	1
2	1401-0816	1/4 X 2 UNC HEX CAP SCR (GR 5)	4
3	144C-0804	1/4 X 1/2 UNC TRUSS HD PH MACH SCR, SS	6
4	144C-0810	1/4 X 1 1/4 UNC TRUSS HD PH MACH SCR, SS	4
5	1478-0800	1/4 UNC HEX NYLOCK NUT (GR B)	5
6	1484-0808	1/4-20 X 7/16 SLAB BASE WELD NUT	6
7	1487-0800	1/4 TYPE A PLAIN WASHER	8
8	15000006	RAMP HOLDER, MALE END	1
9	1504-0204	KEY-T45 TORX	1
10	1504-0207	KEY-6 MM HEX	1
11	1506-0001	M10 X 1.5 X 80 BUTTON HD SOCKET SCREW	2
12	15060048	#10 X 3/4 SS FLAT HD TAP SCR	8
13	70000090	BLOCK-MOUNT, RAMP	1
14	70000091	BLOCK-MOUNT, RAMP	1
15	7800-0011	RECESSED COT CUP	2
16	7800-0016	SUPER SIZED RECESSED COT CUP	1
17	78113000	KIT-RAMP	1
18	78113006	BRACKET-STOP, RAMP	1
19	78113007	STRIP-SUPPORT, DECK	1
20	78113008	GLIDE STRIP	2
21	78113009	SPACER-MOUNT, DECK	2
22	78113010	PLATE-SR75	1



223 15TH ST. NE, SIOUX CENTER, IA 51250  
1-800-248-3057  
[www.linkmortuaryequipment.com](http://www.linkmortuaryequipment.com)