

**LINK[®] MORTUARY
EQUIPMENT**

ASSEMBLY INSTRUCTIONS AND PARTS LIST

**SR50-B
(7810A003)**



223 15th St. N.E.
Sioux Center, IA USA
51250-2120
www.linkmortuaryequipment.com

**QUESTIONS?
CALL CUSTOMER
SERVICE
1-800-248-3057**

The **Link SR50-B** fits 1994 to 2014 Chevrolet Suburban's or GMC Yukon's.

Link Mortuary Equipment, a division of Link Mfg., Ltd.
www.linkmortuaryequipment.com

78104111
AUG 4, 2023

IMPORTANT: IT IS IMPORTANT THAT THE ENTIRE INSTALLATION INSTRUCTIONS BE READ THOROUGHLY BEFORE PROCEEDING WITH THE INSTALLATION.

1. INTRODUCTION

Thank you for choosing a Link Mortuary Equipment SR50-B. We want to help you get the best results from this deck and to operate it safely. This instruction contains information to assist in the installation of the Link Mortuary Equipment SR50-B. This instruction is intended solely for use with this product.

All information in this instruction is based on the latest information available at the time of printing. Link Manufacturing reserves the right to change its products or manuals at any time without notice.

Damaged components should be returned to Link with a pre-arranged Returned Materials Authorization (RMA) number through the Customer Service Department. The damaged component may then be replaced if in compliance with warranty conditions.

Review the **Parts List** on **Page 3** to become familiar with the different components of the **SR50-B**. Be sure all items are included before beginning assembly.

IMPORTANT: Installation of the **SR50-B** may vary depending on what type of vehicle you have and how it is set up. Due to variables in different vehicles, the fit of the **SR50-B** should be evaluated before beginning installation.

1. Remove the ramp (Item #19) from the SR50-B bracketry.
2. Install the ramp stop bracket (Item #17) as shown in Fig. 4. Do not fully tighten the fasteners at this time to allow for alignment with the ramp.
3. Remove the two fasteners from the rear cargo hold-downs of your vehicle (See **Fig. 1**) using the supplied Torx key.
4. Position the SR50-B bracketry in the vehicle and install the two M10 X 80 fasteners (Item #12) using the supplied hex key to securely fasten the unit in place.
5. Install the ramp as shown in **Fig 4**.

NOTE: 1994 to 1999 models will need to install additional spacers (Part #78103104) under each side of the standard bracketry. See **Figs. 2 and 3** for details.

6. Check the alignment of the rubber ramp holder (Item #9) with the side ramp stop bracket when folding the ramp up. Adjust the bracket if necessary, then tighten the fasteners referred to in **Step 2**.

Maintenance:

- A. Clean with soap and water or window cleaner.
- B. Call Link Mfg. 1-800-248-3057 with any questions or comments.

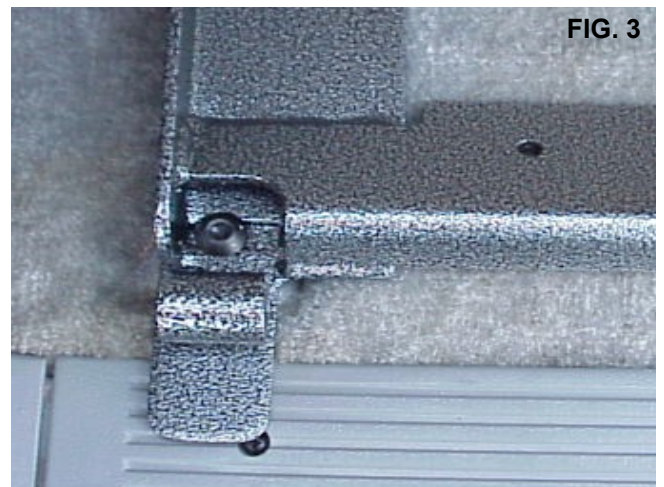
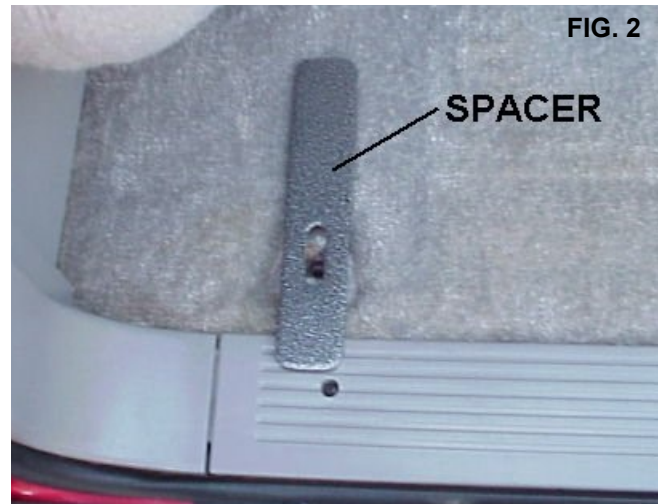

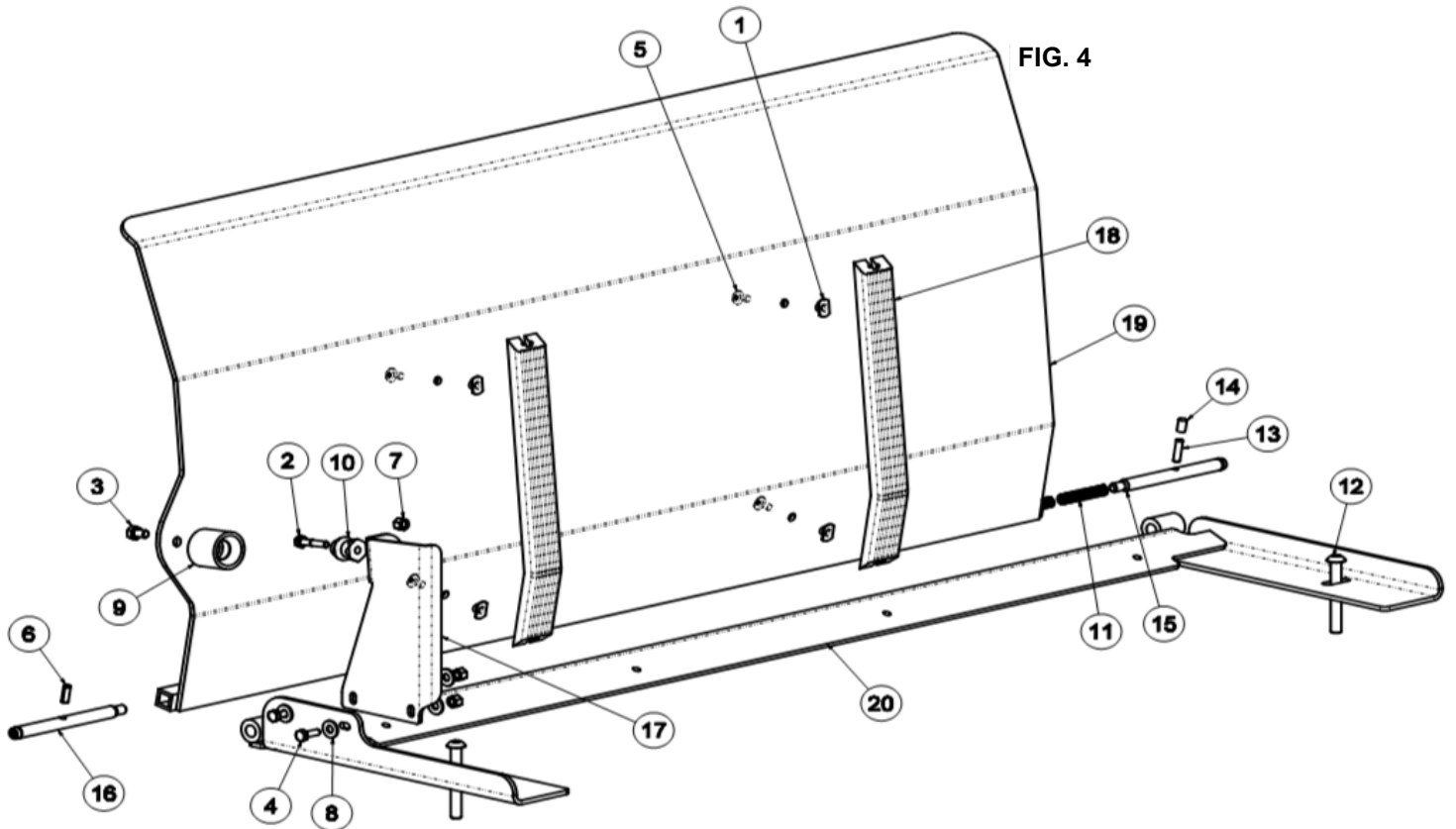

LINK® MODEL "SR50-B" PARTS LIST

ITEM	PART NUMBER	DESCRIPTION	QTY	ITEM	PART NUMBER	DESCRIPTION	QTY
1	15060054	1/4-20 X 1/4 SLAB BASE WELD NUT	4	11	15010001	COMPRESSION SPRING	2
2	14010810	1/4 X 1 1/4 UNC HEX CAP SCR (GR 5)	1	12	15060001	M10 X 1.5 X 80 BUTTON HD SOCKET SCREW	2
3	14011004	5/16 X 1/2 UNC HEX CAP SCR (GR 5)	1	13	15060034	SET SCREW, 1/4-20 UNC X 1.0	1
4	14090806	1/4 X 3/4 UNC HEX CAP SCR, SS	2	14	15070061	PROTECTIVE CAP-VINYL COVER, 3/16 RD X 1/2	1
5	144C0804	1/4 X 1/2 UNC TRUSS HD PH MACH SCR, SS	4	15	70000034	BOLT-HINGE ARM	1
6	14500806	ROLL PIN, 1/4 X 3/4, PLAIN FINISH	2	16	70000036	RAMP PIVOT BOLTS	1
7	14780800	1/4 UNC HEX NYLOCK NUT (GR B)	3	17	78100003	BRACKET-STOP, RAMP	1
8	14870800	1/4 TYPE A PLAIN WASHER	4	18	78100006	GLIDE STRIP	2
9	15000003	RAMP HOLDER, FEMALE END	1	19	78101100	RAMP WELDMENT	1
10	15000004	RAMP HOLDER, MALE END	1	20	78103100	PLATE-MOUNT, RAMP	1



223 15TH ST. NE, SIOUX CENTER, IA 51250
1-800-248-3057
www.linkmortuaryequipment.com