



223 15th St. N.E.
Sioux Center, IA USA
51250-2120
www.linkmortuaryequipment.com

QUESTIONS?
CALL CUSTOMER
SERVICE
1-800-248-3057

INSTALLATION INSTRUCTIONS

DD4000 (7225D002)



The **Link DD4000** fits 2016 and newer Promaster 159 EXT van.

Link Mortuary Equipment, a division of Link Mfg., Ltd.
www.linkmortuaryequipment.com

72250077
AUG 3, 2023

IMPORTANT: IT IS IMPORTANT THAT THE ENTIRE INSTALLATION INSTRUCTIONS BE READ THOROUGHLY BEFORE PROCEEDING WITH THE INSTALLATION.







1. INTRODUCTION

Thank you for choosing a Link Mortuary Equipment DD4000. We want to help you get the best results from this deck system and to operate it safely. This manual contains information to assist in the installation and operation of your Link Mortuary Equipment DD4000. This instruction is intended solely for use with this product.

All information in this instruction is based on the latest information available at the time of printing. Link Manufacturing reserves the right to change its products or manuals at any time without notice.

Damaged components should be returned to Link with a pre-arranged Returned Materials Authorization (RMA) number through the Customer Service Department. The damaged component may then be replaced if in compliance with warranty conditions.

2. SAFETY SYMBOLS, TORQUE SYMBOL, and NOTES

| | |
|--|---|
|  DANGER | DANGER indicates a hazardous situation which if not avoided, will result in death or serious injury. |
|  WARNING | WARNING indicates a potentially hazardous situation which, if not avoided, could result in death or serious injury. |
|  CAUTION | CAUTION indicates a potentially hazardous situation which, if not avoided, could result in minor or moderate injury. |
|  NOTICE | NOTICE indicates a potentially hazardous situation which, if not avoided, may result in property damage. |
|  TORQUE | TORQUE indicates named fasteners are to be tightened to a specified torque value. |
| NOTE: | A Note provides information or suggestions that help you correctly perform a task. |
|  | The electrical symbol indicates the presence of electric shock hazards which, if not avoided, may result in injury to personnel or damage to equipment. |

3. SAFE WORKING PRACTICES

 **CAUTION** When handling parts, wear appropriate gloves, eyeglasses, ear protection, and other safety equipment.

 **CAUTION** Practice safe lifting procedures.

 **CAUTION** The deck weldments are heavy, and can cause injury if lifted improperly or dropped. Consider size, shape, and weight of objects being moved.

 **CAUTION** Obtain help or the assistance of a crane when lifting heavy assemblies. Make certain the path of travel is clear.

4. OPERATION GUIDELINES

- 4.1. Vehicle must have a bulkhead installed contact Link Mortuary Equipment at (800)-248-3057 to order one if your vehicle is not equipped with one.
- 4.2. In order for this deck to operate properly, it must operate in the parameters specified by Link.
- 4.3. The installer must verify the vehicle is configured properly for the deck being added.
- 4.4. No alterations of any Link deck component is permitted without proper authorization from qualified Link personnel.
- 4.5. No welding of any deck component is permitted except when specified by Link.

 **CAUTION** The vehicle manufacturer should be consulted before any modifications are made to the frame of the vehicle.

 **CAUTION** Cutting or altering the frame in certain areas may affect the manufacturer's warranty.

 **WARNING** Proper tightening of fasteners is important to the performance and safety of the deck.

 **WARNING** Improperly tightened fasteners may cause unsafe conditions and accelerate wear .

5. PRE-INSTALLATION CHECKLIST

- ☐ Make certain the vehicle is placed on a level flat surface and that the parking brake is engaged.

⚠ WARNING ⚠ Follow the vehicle manufacturer recommendations located in the owner's manual pertaining to accidental air bag deployment whenever performing service on system wiring.

⚠ WARNING ⚠ If in doubt, contact the vehicle manufacturer.

6. INSTALLATION PROCEDURE

The following steps are instructions for installing the DD4000C system. Refer to pictures and **Parts Lists** for details.

6.1 Remove the eight rear cargo loops. (FIG. 1)

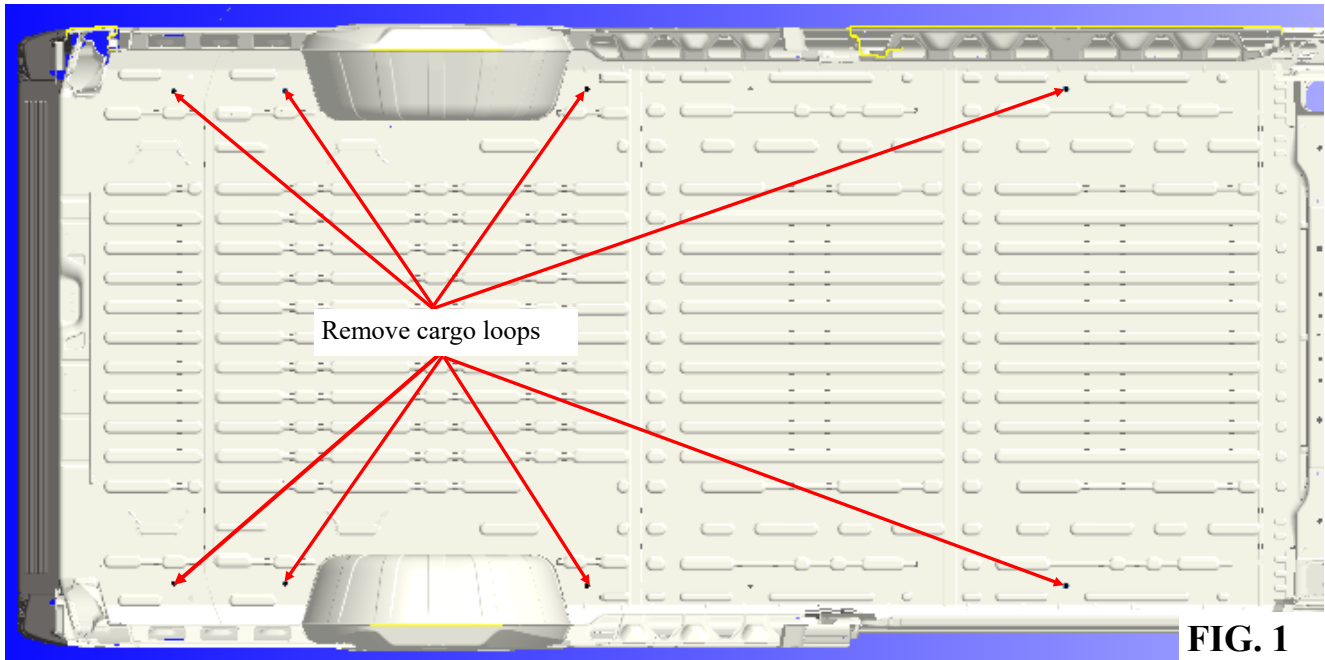

FIG. 1

6.2 Set the main rear weldment in place. Center it about the 4 cargo loop holes. Loosely install the four supplied 8mm bolts and washers. Square the rear section with the rear of the van and tighten bolts. DO NOT OVER TIGHTEN. (FIG. 2a & 2b)

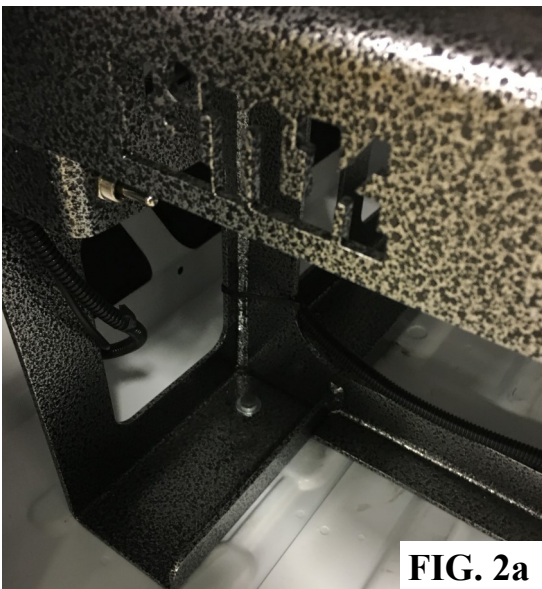

FIG. 2a

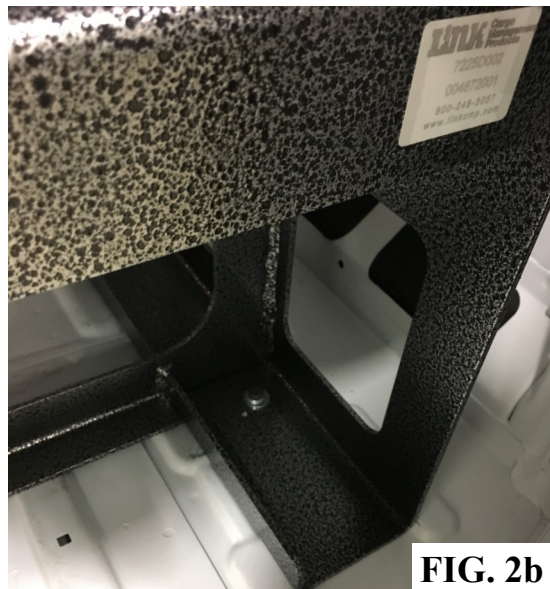

FIG. 2b

6. INSTALLATION PROCEDURE (CONT')

6.5 Wiring: part 1

6.3.1 Attach the black ground to the vehicle ground located above rear door using the prewired ring terminal.

6.3.2 String the system's red power wire from the switch through the taillight access cover on the drivers side. (You will need to cut a small hole in this cover to allow clearance for the wire.) Run the wire up the rear pillar to the roof. Then follow the existing wire loom to the bulk head behind the drivers seat. **(FIG.3)**

6.3.3 Then run the wire to the floor attaching it to the bulkhead using plastic loops and self tapping screws. **(FIG.4)**

6.3.4 Route the wire through the bulkhead to the area underneath the driver's seat. Then route it through the hole under the driver's seat and to the power supply. **(FIG. 5)**

Do not attach to power supply at this time.



6.4 Attach the channel with the actuator (loosely pre-installed) to the rear weldment using the 4 provided fasteners. Drill (4x) 29/64" holes through the floor and mount in place. **(FIG. 6)**

NOTE: Plug the actuator into the harness coming from the switch.

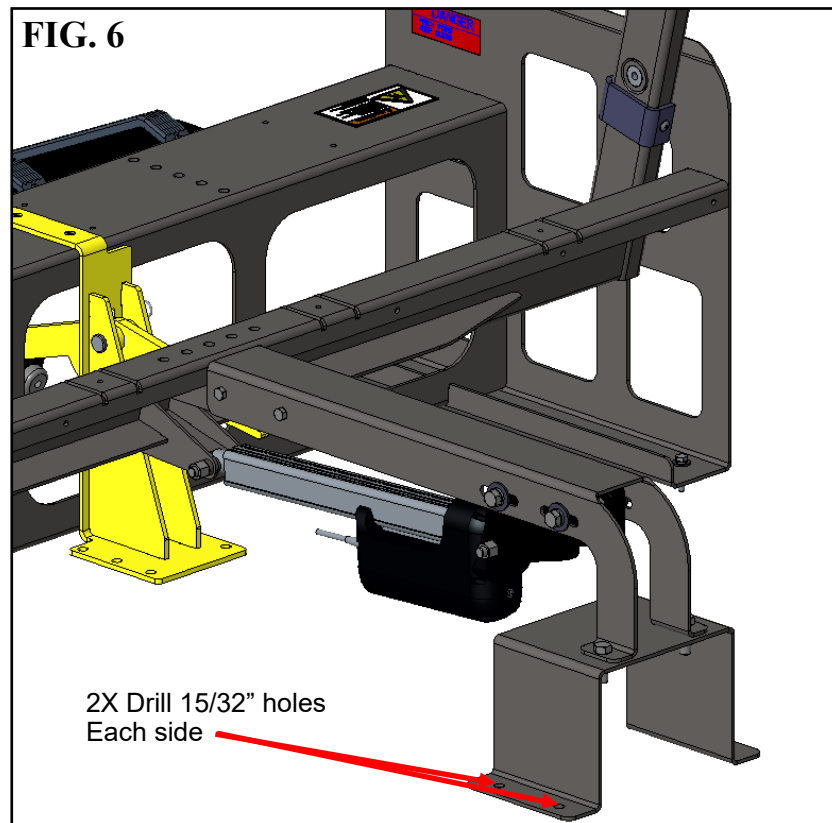

6. INSTALLATION PROCEDURE (CONT')

6.5 Fasten the yellow top deck latch assembly to the van floor. **(FIG.7)** Drill (4x) 29/64" holes through the floor and mount in place with provided fasteners and under-floor backer plate. **(FIG.8)**

⚠ CAUTION Spare tire is mounted under floor in this area. Lower spare tire before drilling to avoid damage to rim and tire.

⚠ CAUTION Take care to avoid damaging tire or rim.

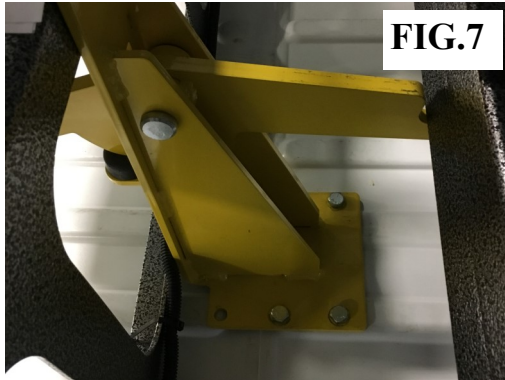

6.6 Install the lift arm weldment. Assemble the flanged plastic bearings into the side plates. Hold the lift arm in place and slide the pivot pins through the lift arm into the bushings from the inside. Lock the pins in place using the set screws and jam nuts. **(FIG.9)** Then connect to the actuator using the provided bolt and lock nut. **(FIG.10)**

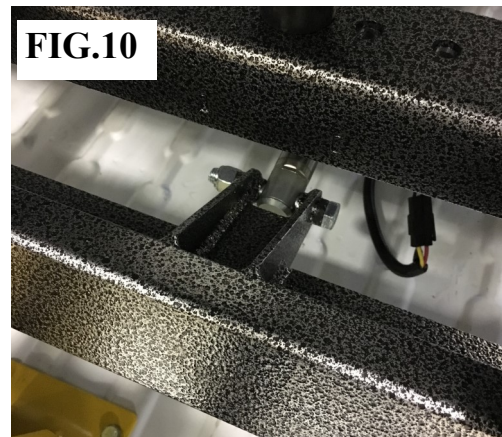
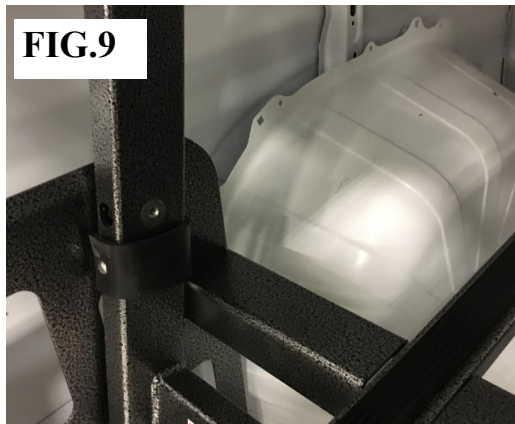

6.7 Using the provided ring terminal, hook up the power wire to Terminal under the drivers floor. **(FIG.11)**

6.8 Test the actuator for function by toggling the switch up and down.

Be sure to raise and hold the yellow handle to disengage the top deck latch before running the lift arm down.

6.9 Secure the actuator wires to the rear weldment using cable ties.

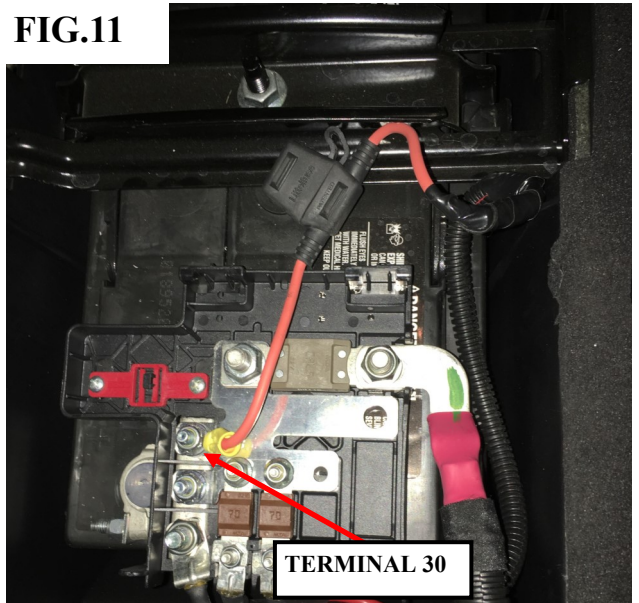

6. INSTALLATION PROCEDURE (CONT')

- 6.10 Attach the two legs with the bumpers to the front of the bottom deck with the bumpers facing forward of the deck. **(FIG.12)**
- 6.12 Attach the two side legs to the bottom deck with the bracket leg facing outboard. **(FIG.13)**

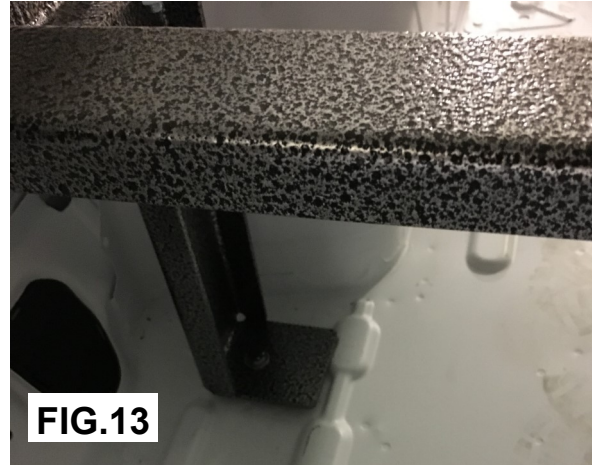
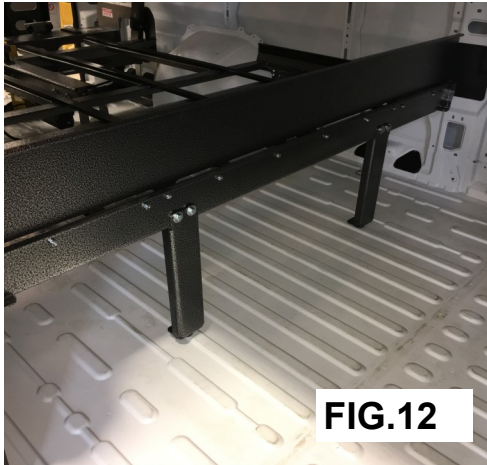

- 6.11 Set the bottom deck and the four connecting channels into the van.
- 6.12 Install the glide strips on the bottom deck.
- 6.13 Attach the two side legs to the floor of the vehicle using the holes for the cargo loops and 8mm bolts supplied.
- 6.14 Set in the front legs and bolt together with the cross straps. **(FIG.14)**

NOTE: Do not bolt in place at this time.

- 6.15 Set in the top deck and install the front pivot bolts. **(FIG.15)**

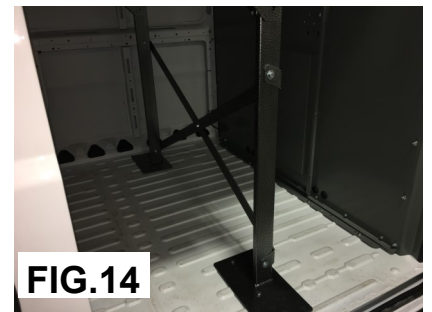
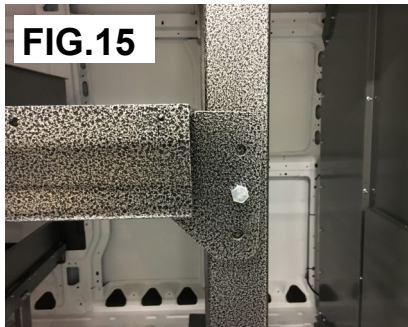

NOTE: Use middle hole for low roof vans, and the bottom hole for high roof vans on top. The bearing in the lift arm will need to be moved to the corresponding hole. **(FIG.16)**

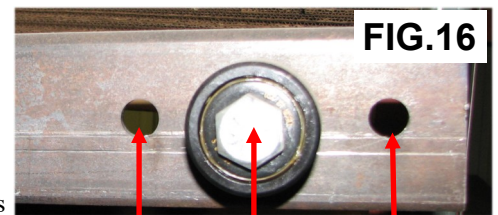

This hole can also be used on Low Roof vans where more room is needed on the top deck.

Low Roof

High Roof

6. INSTALLATION PROCEDURE (CONT')

6.16 Install the top deck roller guide channels. (**FIG.17**)

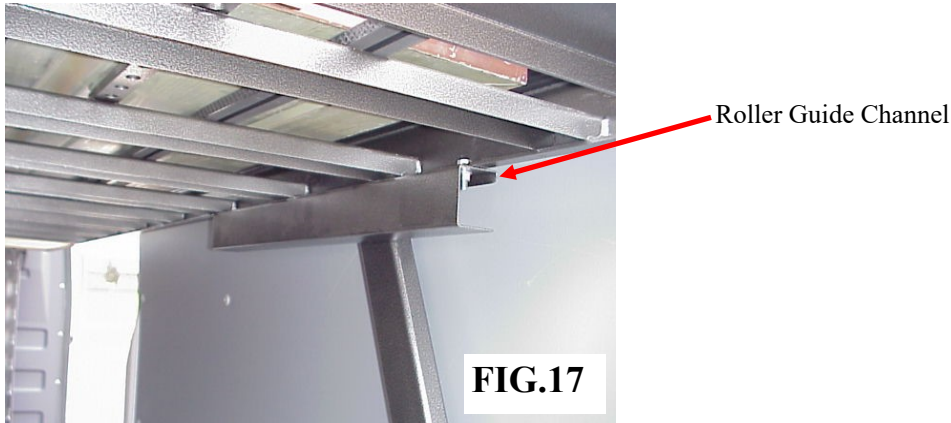

6.17 Center the front legs L to R (the edge of the plate on the front leg should be even with the edge of the side step). The legs should be about 2" from the bulkhead at the floor (make sure they are at the same distance.) Drill 7/16" hole through the floor (4x) and bolt in place. (**FIGS.18&19**)

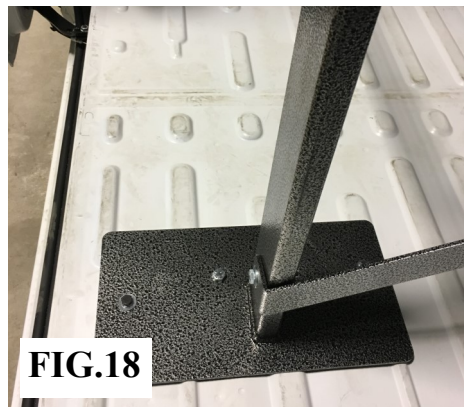

6.18 Loosely attach the front top brackets to the front legs, then attach to the roof cross member. A 3/8" hole will need to be drilled (2x). The holes should be 5.00" outward from the outermost holes in the roof cross member. (**FIG.20**)



6. INSTALLATION PROCEDURE (CONT')

- 6.19 With the top deck lowered, align the rear of the deck correctly over the lower deck, then tighten the 4 fasteners that tie the roof brackets to the front legs. **(FIG.22&23)**



- 6.20 Adjust the actuator to the correct position (Suggestion: Place a 1" thick spacer between the decks with the actuator fully extended) and tighten the 4 actuator bolts. **(FIG.24)**

Actuator
Bolts
(2 per side)

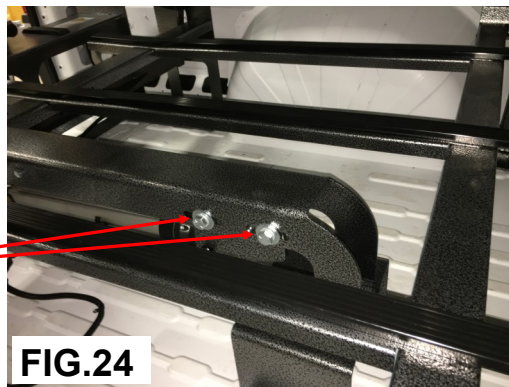

- 6.21 Attach the ramps to the rear of the bottom deck. **(FIG.25&26)**

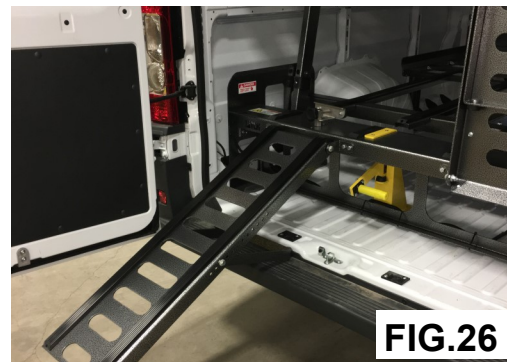
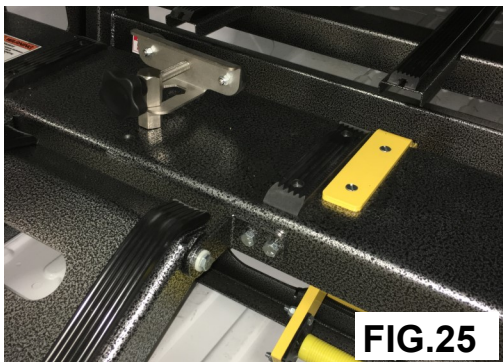

- 6.22 Attach the bumpers to the ramps. Position the bumpers so the doors contact them when they are closed. **(FIG.27&28)**



DD4000 PARTS

Actuator Mount Assembly

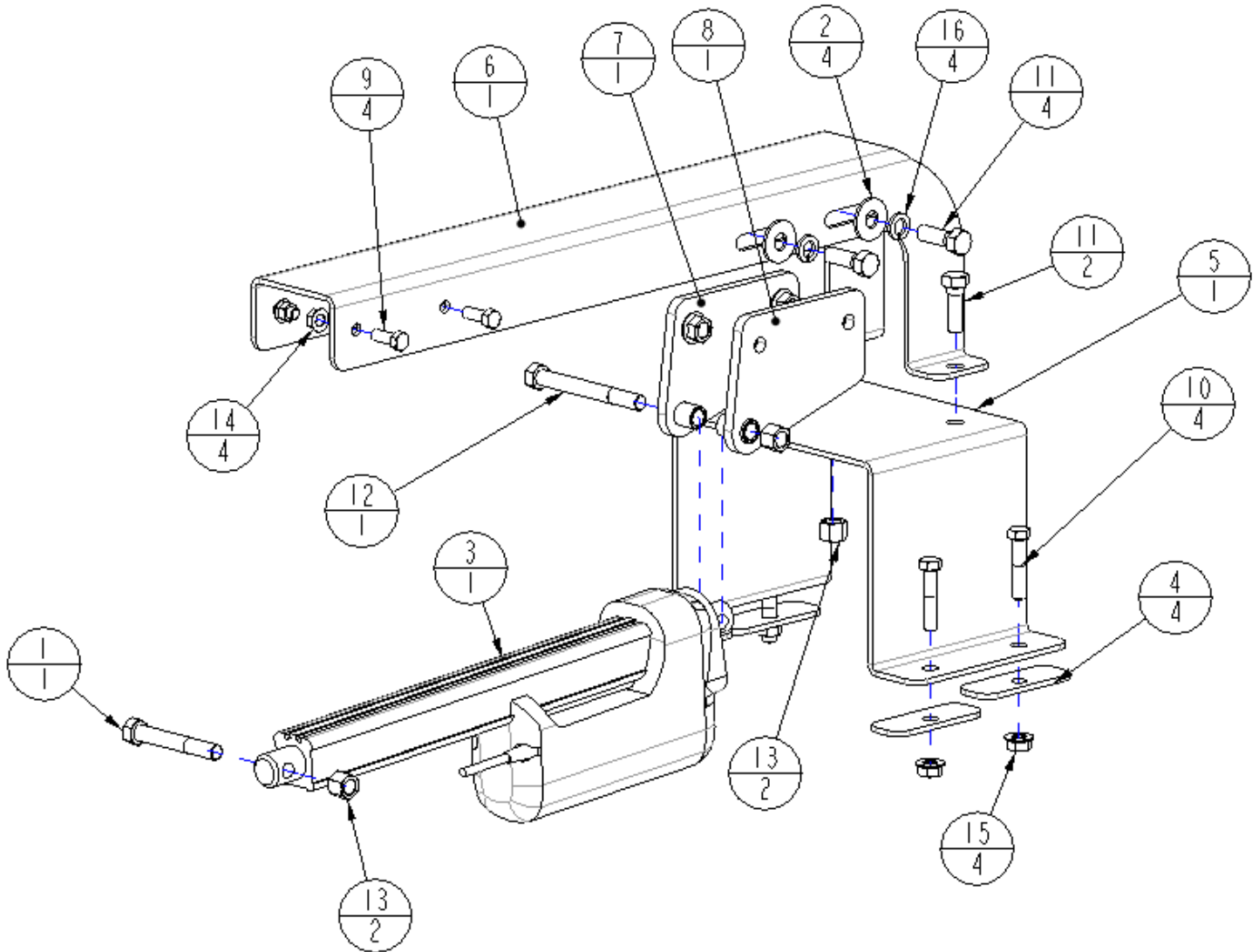

| ITEM | PART # | DESCRIPTION | QTY |
|------|----------|------------------------------------|-----|
| 1 | 14011628 | 1/2 X 3 1/2 UNC HEX CAP SCR (GR 5) | 1 |
| 2 | 14871600 | 1/2 TYPE A PLAIN WASHER | 4 |
| 3 | 15040314 | ACTUATOR, 12V, 300MM STROKE, 6800N | 1 |
| 4 | 72250052 | PLATE-WASHER | 4 |
| 5 | 72250089 | BRACKET-MOUNT | 1 |
| 6 | 72252030 | CHANNEL-MOUNT, ACTUATOR | 1 |
| 7 | 72252107 | WELDMENT-MOUNT, ACTUATOR | 1 |
| 8 | 72252108 | WELDMENT-MOUNT, ACTUATOR | 1 |
| 9 | 14011208 | 3/8 X 1 UNC HEX CAP SCR (GR 5) | 4 |
| 10 | 14011416 | 7/16 X 2 UNC HEX CAP SCR (GR 5) | 4 |
| 11 | 14011612 | 1/2 X 1 1/2 UNC HEX CAP SCR (GR 5) | 6 |
| 12 | 14011636 | 1/2 X 4 1/2 UNC HEX CAP SCR (GR 5) | 1 |
| 13 | 14781600 | 1/2 UNC HEX NYLOCK NUT (GR B) | 4 |
| 14 | 14801200 | 3/8 UNC SERRATED FLANGE NUT | 4 |
| 15 | 14801400 | 7/16 UNC SERRATED FLANGE NUT | 4 |
| 16 | 14851600 | 1/2 LOCK WASHER | 4 |

DD4000 PARTS

Rear Weldment Assembly

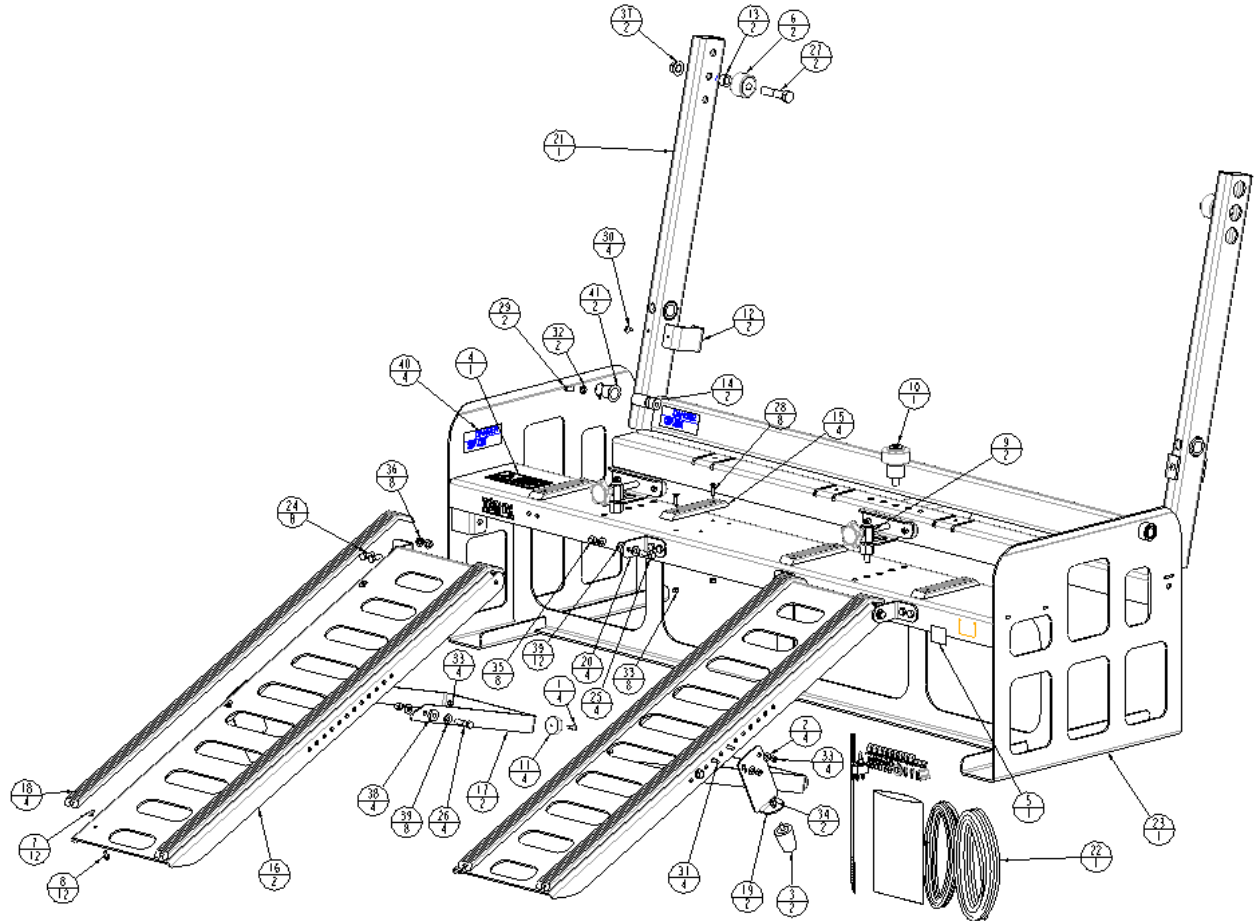

| ITEM | PART # | DESCRIPTION | QTY | ITEM | PART # | DESCRIPTION | QTY |
|------|----------|--|-----|------|----------|--|-----|
| 1 | 14420806 | 1/4 X 3/4 UNC PAN HD PH MACH SCR, ZINC | 4 | 22 | 72252109 | KIT-ELECTRICAL, DD4000 | 1 |
| 2 | 14870800 | 1/4 TYPE A PLAIN WASHER | 4 | 23 | 72252115 | WELDMENT-BOTTOM | 1 |
| 3 | 15000005 | BUMPER-NEOPRENE RUBBER | 2 | 24 | 14011208 | 3/8 X 1 UNC HEX CAP SCR (GR 5) | 8 |
| 4 | 15001375 | LABEL-WARNING, DOUBLE DECK | 1 | 25 | 14011210 | 3/8 X 1 1/4 UNC HEX CAP SCR (GR 5) | 4 |
| 5 | 15001380 | LABEL-ID | 1 | 26 | 14011212 | 3/8 X 1 1/2 UNC HEX CAP SCR (GR 5) | 4 |
| 6 | 15040312 | ROLLER-TRACK | 2 | 27 | 14012022 | 5/8 X 2 3/4 UNC HEX CAP SCR (GR 5) | 2 |
| 7 | 15060054 | 1/4-20 X 1/4 SLAB BASE WELD NUT | 16 | 28 | 14150808 | 1/4 X 1 UNC SLTD FTHD CSK MACH SCR | 8 |
| 8 | 15060418 | 1/4 X 3/8 FLANGE HEAD BOLT | 16 | 29 | 14401207 | 3/8 X 7/8 UNC HEX SOCKET SET SCREW | 2 |
| 9 | 15070275 | PIN-BIER, ADJUSTABLE | 2 | 30 | 144C0804 | 1/4 X 1/2 UNC TRUSS HD PH MACH SCR, SS | 4 |
| 10 | 15070303 | ROLLER-BIER | 1 | 31 | 144C0806 | 1/4 X 3/4 UNC TRUSS HD PH MACH SCR, SS | 4 |
| 11 | 15070407 | BUMPER-RECESSED, 1.50 O.D. X .63 H | 4 | 32 | 14741200 | 3/8 UNC HEX JAM NUT | 2 |
| 12 | 15070477 | BUMPER-.25 X 2.00 X 5.63 | 2 | 33 | 14780800 | 1/4 UNC HEX NYLOCK NUT (GR B) | 16 |
| 13 | 72250047 | BUSHING-SPACER | 2 | 34 | 14781000 | 5/16 UNC HEX NYLOCK NUT (GR B) | 2 |
| 14 | 72250048 | PIN-PIVOT | 2 | 35 | 14781200 | 3/8 UNC HEX NYLOCK NUT (GR B) | 8 |
| 15 | 72250065 | GLIDE STRIP | 4 | 36 | 14801200 | 3/8 UNC SERRATED FLANGE NUT | 8 |
| 16 | 72250090 | PLATE-RAMP | 2 | 37 | 14802003 | 5/8 UNC TOP LOCK FL NUT (GR G) | 2 |
| 17 | 72250091 | LEG-RAMP | 2 | 38 | 14910003 | NYLON WASHER | 4 |
| 18 | 72250093 | GLIDE STRIP | 4 | 39 | 14916405 | WASHER-NYLON | 20 |
| 19 | 72250099 | BRACKET-BUMBER,RAMP | 2 | 40 | 15001311 | DECAL-PINCH POINT | 4 |
| 20 | 72252019 | BRACKET-MOUNT, RAMP | 4 | 41 | 15040092 | FLANGED BEARING (THOMSON TYPE 6) | 2 |
| 21 | 72252101 | ARM-LIFT | 1 | | | | |

DD4000 PARTS

Upper Deck Assembly

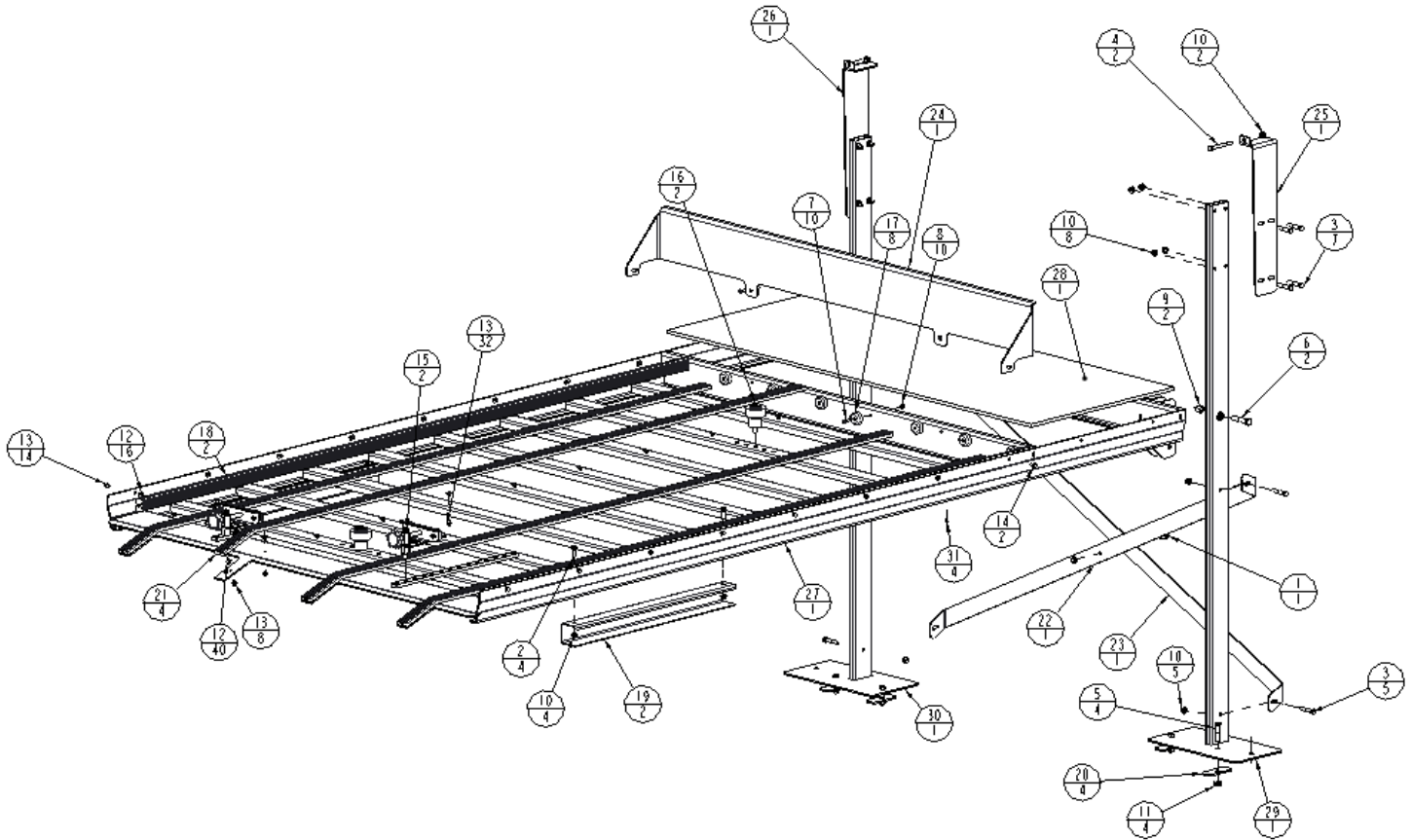

| ITEM | PART # | DESCRIPTION | QTY | ITEM | PART # | DESCRIPTION | QTY |
|------|----------|--|-----|------|----------|------------------------------------|-----|
| 1 | 14011206 | 3/8 X 3/4 UNC HEX CAP SCR (GR 5) | 1 | 17 | 15070407 | BUMPER-RECESSED, 1.50 O.D. X .63 H | 8 |
| 2 | 14011208 | 3/8 X 1 UNC HEX CAP SCR (GR 5) | 4 | 18 | 72250036 | GLIDE STRIP | 2 |
| 3 | 14011216 | 3/8 X 2 UNC HEX CAP SCR (GR 5) | 12 | 19 | 72250045 | CHANNEL-TRACK, ROLLER | 2 |
| 4 | 14011228 | 3/8 X 3 1/2 UNC HEX CAP SCR (GR 5) | 2 | 20 | 72250052 | PLATE-WASHER | 4 |
| 5 | 14011416 | 7/16 X 2 UNC HEX CAP SCR (GR 5) | 4 | 21 | 72250063 | GLIDE STRIP | 4 |
| 6 | 14011620 | 1/2 X 2 1/2 UNC HEX CAP SCR (GR 5) | 2 | 22 | 72250070 | STRAP-BRACE | 1 |
| 7 | 14420806 | 1/4 X 3/4 UNC PAN HD PH MACH SCR, ZINC | 10 | 23 | 72250071 | STRAP-BRACE | 1 |
| 8 | 14780800 | 1/4 UNC HEX NYLOCK NUT (GR B) | 10 | 24 | 72250074 | CATCH-FRONT, UPPER | 1 |
| 9 | 14781600 | 1/2 UNC HEX NYLOCK NUT (GR B) | 2 | 25 | 72250085 | BRACKET-ROOF | 1 |
| 10 | 14801200 | 3/8 UNC SERRATED FLANGE NUT | 19 | 26 | 72250086 | BRACKET-ROOF | 1 |
| 11 | 14801400 | 7/16 UNC SERRATED FLANGE NUT | 4 | 27 | 72251009 | WELDMENT-DECK, TOP | 1 |
| 12 | 15060054 | 1/4-20 X 1/4 SLAB BASE WELD NUT | 56 | 28 | 72252010 | BOARD-DECK | 1 |
| 13 | 15060418 | 1/4 X 3/8 FLANGE HEAD BOLT | 54 | 29 | 72252116 | POST-SUPPORT, DECK | 1 |
| 14 | 15060420 | 1/4 X 5/8 FLANGE HEAD BOLT | 2 | 30 | 72252117 | POST-SUPPORT, DECK | 1 |
| 15 | 15070275 | PIN-BIER, ADJUSTABLE | 2 | 31 | 14590C06 | NO 8 X .375 CR PN HD TAPPING SCR | 4 |
| 16 | 15070303 | ROLLER-BIER | 2 | | 15060420 | 1/4 X 5/8 FLANGE HEAD BOLT | 2 |

DD4000 PARTS

Lower Deck Assembly

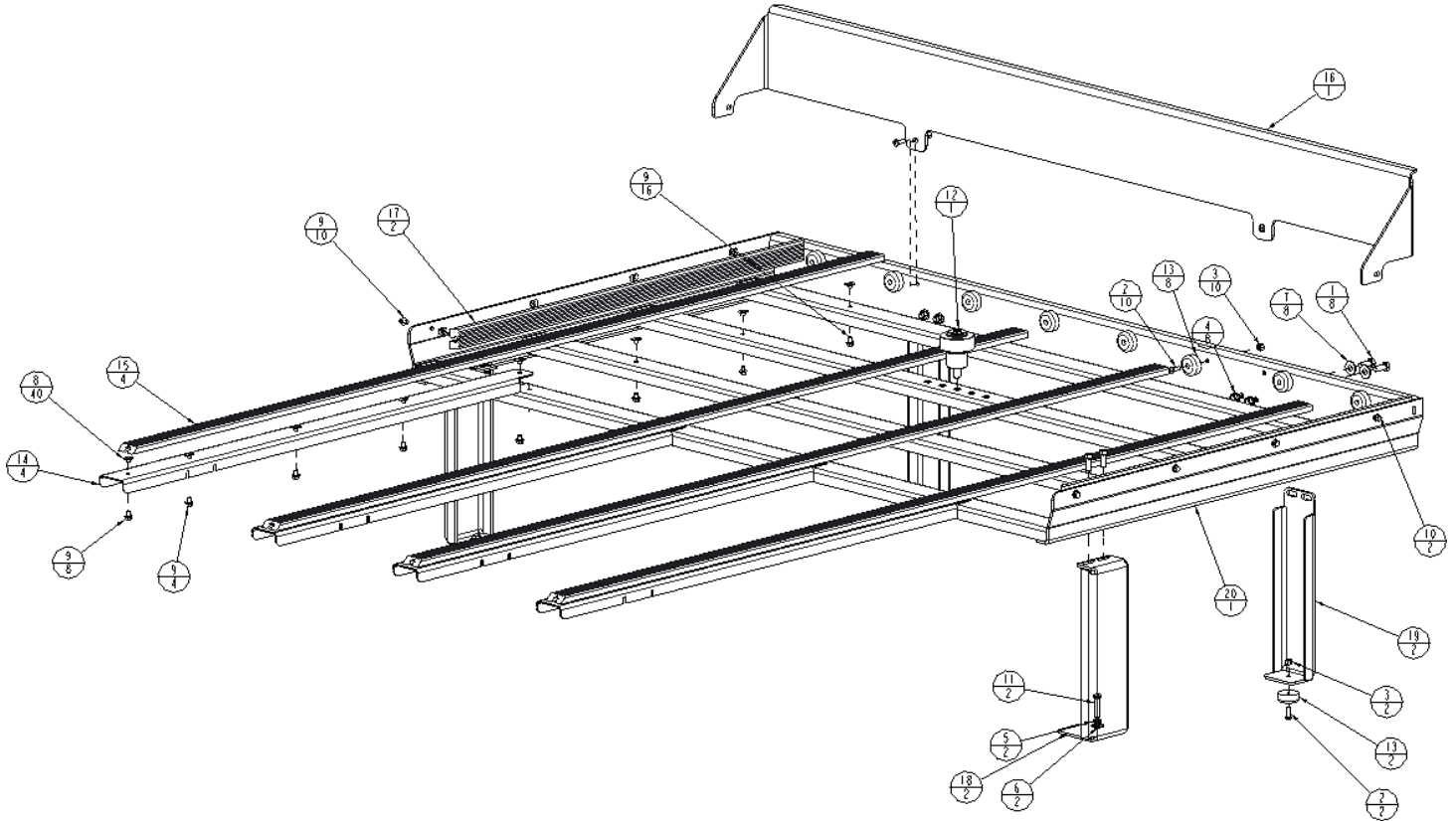

| ITEM | PART # | DESCRIPTION | QTY | ITEM | PART # | DESCRIPTION | QTY |
|------|----------|--|-----|------|----------|---|-----|
| 1 | 14011208 | 3/8 X 1 UNC HEX CAP SCR (GR 5) | 8 | 11 | 15060450 | HEX CAP SCREW, M8 X 1.25 X 40, CLASS 10.9 | 2 |
| 2 | 14420806 | 1/4 X 3/4 UNC PAN HD PH MACH SCR, ZINC | 12 | 12 | 15070303 | ROLLER-BIER | 1 |
| 3 | 14780800 | 1/4 UNC HEX NYLOCK NUT (GR B) | 12 | 13 | 15070407 | BUMPER-RECESSED, 1.50 O.D. X .63 H | 10 |
| 4 | 14801200 | 3/8 UNC SERRATED FLANGE NUT | 8 | 14 | 72250039 | CHANNEL-SUPPORT, GLIDE | 4 |
| 5 | 14851000 | 5/16 LOCK WASHER | 2 | 15 | 72250049 | GLIDE STRIP | 4 |
| 6 | 14871000 | 5/16 TYPE A PLAIN WASHER | 2 | 16 | 72250075 | CATCH-FRONT, LOWER | 1 |
| 7 | 14871200 | 3/8 TYPE A PLAIN WASHER | 8 | 17 | 72250080 | GLIDE STRIP | 2 |
| 8 | 15060054 | 1/4-20 X 1/4 SLAB BASE WELD NUT | 40 | 18 | 72250087 | BRACKET | 2 |
| 9 | 15060418 | 1/4 X 3/8 FLANGE HEAD BOLT | 38 | 19 | 72250088 | BRACKET-SUPPORT, DECK | 2 |
| 10 | 15060420 | 1/4 X 5/8 FLANGE HEAD BOLT | 2 | 20 | 72252105 | DECK-BOTTOM | 1 |

DD4000 PARTS

Deck Latch Assembly

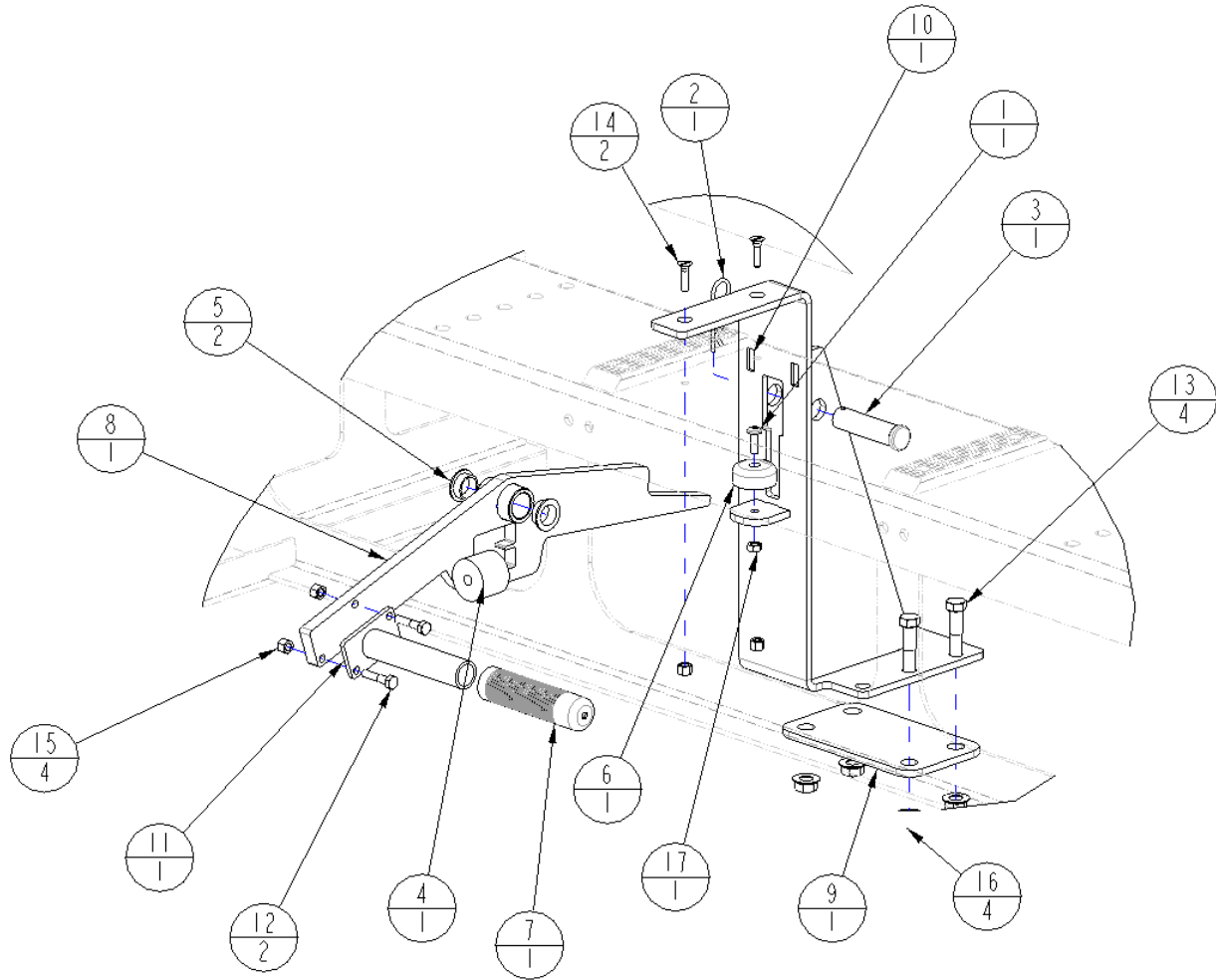

| ITEM | PART # | DESCRIPTION | QTY |
|------|-----------|--|-----|
| 1 | 14420806 | 1/4 X 3/4 UNC PAN HD PH MACH SCR, ZINC | 1 |
| 2 | 14490002 | PIN-COTTER, 1/8 X 2 1/2 | 1 |
| 3 | 14510004 | PIN-CLEVIS, 3" X 3/4" | 1 |
| 4 | 15000929 | BUMPER-SPRING | 1 |
| 5 | 15040098 | BUSHING-PIVOT, NYLON, 3/8 | 2 |
| 6 | 15070407 | BUMPER-RECESSED, 1.50 O.D. X .63 H | 1 |
| 7 | 15070476 | GRIP-VINYL, ROUND | 1 |
| 8 | 72251031 | WELDMENT-HANDLE, LATCH | 1 |
| 9 | 72251033 | PLATE-BACKING | 1 |
| 10 | 72252118 | WELDMENT-MOUNT, LATCH | 1 |
| 11 | 78552213 | HANDLE-RAMP | 1 |
| 12 | 1401-0810 | 1/4 X 1 1/4 UNC HEX CAP SCR (GR 5) | 2 |
| 13 | 1401-1416 | 7/16 X 2 UNC HEX CAP SCR (GR 5) | 4 |
| 14 | 1415-0808 | 1/4 X 1 UNC SLTD FTHD CSK MACH SCR | 2 |
| 15 | 1478-0800 | 1/4 UNC HEX NYLOCK NUT (GR B) | 4 |
| 16 | 1480-1400 | 7/16 UNC SERRATED FLANGE NUT | 4 |
| 17 | 1484-0810 | 1/4 UNC HEX CTR LOCK NUT, SS | 1 |



223 15TH ST. NE, SIOUX CENTER, IA 51250
1-800-248-3057
www.linkmortuaryequipment.com