

**LINK**<sup>®</sup> MORTUARY  
EQUIPMENT

# INSTALLATION INSTRUCTIONS

## SS150 SINGLE DECK CARGO VANS



223 15th St. N.E.  
Sioux Center, IA USA  
51250-2120  
[www.linkmortuaryequipment.com](http://www.linkmortuaryequipment.com)

**QUESTIONS?  
CALL CUSTOMER  
SERVICE  
1-800-248-3057**

The **Link SS150** fits most cargo vans.

Estimated weight: 135 lbs.

Link Mortuary Equipment, a division of Link Mfg., Ltd.  
[www.linkmortuaryequipment.com](http://www.linkmortuaryequipment.com)

71353102  
July 28, 2023

# 1. INTRODUCTION

Thank you for choosing a Link Mortuary Equipment SS150 for Single Deck Cargo Vans. We want to help you to get the best results from the deck and to operate it safely. This manual contains information to introduce you to the Link SS150 and to assist you with its installation. The manual is intended solely for use with this product.

All information in this manual is based on the latest information available at the time of printing. Link Manufacturing reserves the right to change its products or manuals at any time without notice. Contact Link Mortuary Equipment at (800) 248-3057 for information on recent changes to products.

Damaged components should be returned to Link with a pre-arranged Returned Goods Authorization (RGA) number through the Customer Service Department. The damaged component may then be replaced if in compliance with warranty conditions.

# 2. SAFETY SYMBOL and NOTES

 <b>WARNING</b>	<b>WARNING</b> indicates a potentially hazardous situation which, if not avoided, could result in death or serious injury.
<b>NOTE:</b>	A Note provides information or suggestions that help you correctly perform a task.

 **WARNING** Link products must be installed by a trained technician when being placed into an Electric Vehicle (EV). Electric Vehicles have higher voltage batteries and cables, and drilling into Electric Vehicles may cause serious bodily harm and possibly death.

**NOTE:** Link is not responsible for optional configurations or equipment that restrict the installation of the product in any way. Consult OEM body builder guides for additional installation guidelines.

**IMPORTANT:** Installation of the **SS150** may vary depending on what type of vehicle you have and how you have it set up. Due to variables in different vehicles, the fit of the **SS150** should be evaluated before beginning installation.

- A. The **SS150** is shipped with the *bier pin* and *hardware kit* attached to the deck. Remove these items. The *ramp assembly* is installed backwards for shipping. Remove, reverse, and reinstall the *ramp assembly* as shown in **Fig. 1** on Page 1.
- B. Position the deck with a 1" gap between the rear of the deck and the steel lip on the doorframe. Center the deck between the wheel wells.
- C. With the deck positioned, check all clearance issues. Leave adequate clearance between the deck/ramp and any existing van components.
- D. Align the *hold down brackets* that were supplied with the deck to the holes on the side of the deck. Use the rear holes on electric vehicles due to the battery in the middle of the vehicle. Additional holes may need to be drilled into the side of the deck if the existing holes do not have clearance underneath the vehicle.
- E. Check for any interferences under the van to make sure all parts are clear of the exhaust pipe and fuel tanks. Once all clearances have been verified, drill the mounting holes through the van floor with a 7/16" bit, using the holes in the *hold down brackets* as a guide. Drill with caution.
- F. Install the stud through the floor and tighten the nuts securely. (See **Figs. 2 and 4**).
- G. Install the bolts through the side of the deck and securely tighten the small plastic knobs as shown in **Figs. 2 and 4**. The large knobs are then used to secure the deck to the floor.
- H. **Recheck the *ramp assembly* for proper operation.**

### Maintenance:

- A. Clean with soap and water or window cleaner.
- B. Call Link Mfg. 1-800-248-3057 with any questions or comments.



FIG. 3

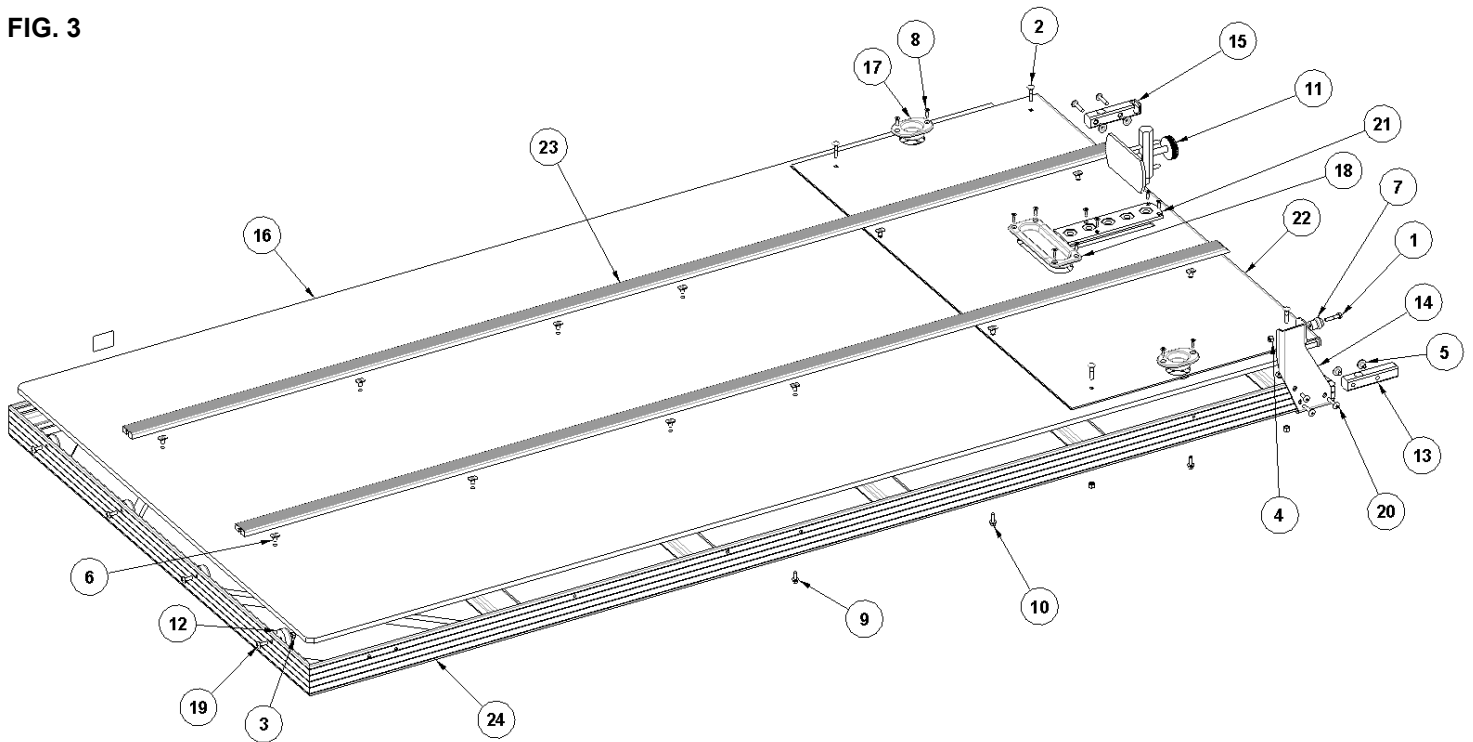

**PARTS LIST FOR SS150 SINGLE DECK (7135X004)**

ITEM	DESCRIPTION	QTY	ITEM	DESCRIPTION	QTY
1	1/4 X 1 1/4 UNC HEX CAP SCR	1	13	TUBE-MOUNT, RAMP	1
2	1/4 X 1 1/4 UNC RND HD SQ NK BOLT	4	14	BRACKET-STOP, RAMP	1
3	1/4 UNC HEX NUT	4	15	TUBE-MOUNT, RAMP	1
4	1/4 UNC HEX NYLOCK NUT	6	16	DECK BOARD	1
5	NUT 1/4-20 X 7/16 HT PROPELLER TEE	4	17	RECESSED COT CUP	2
6	1/4-20 X 7/16 SLAB BASE WELD NUT	12	18	SUPER SIZED RECESSED COT CUP	1
7	RAMP HOLDER, MALE END	1	19	1/4 X 3/4 UNC TRUSS HD PH MACH SCR	5
8	#10 X 3/4 SS FLAT HD TAP SCR	12	20	1/4 X 1 1/4 UNC TRUSS HD PH MACH SCR	4
9	1/4 X 5/8 FLANGE HEAD BOLT	8	21	BIER PIN PLATE (5 HOLE)	1
10	1/4 X 3/4 FLANGE HEAD BOLT	4	22	REAR ANGLE GUARD	1
11	BIER PIN-ADJUSTABLE	1	23	GLIDE STRIP	2
12	BUMPER-RECESSED, 1.50 O.D. X .63 H	4	24	DECK WELDMENT	1

FIG. 4

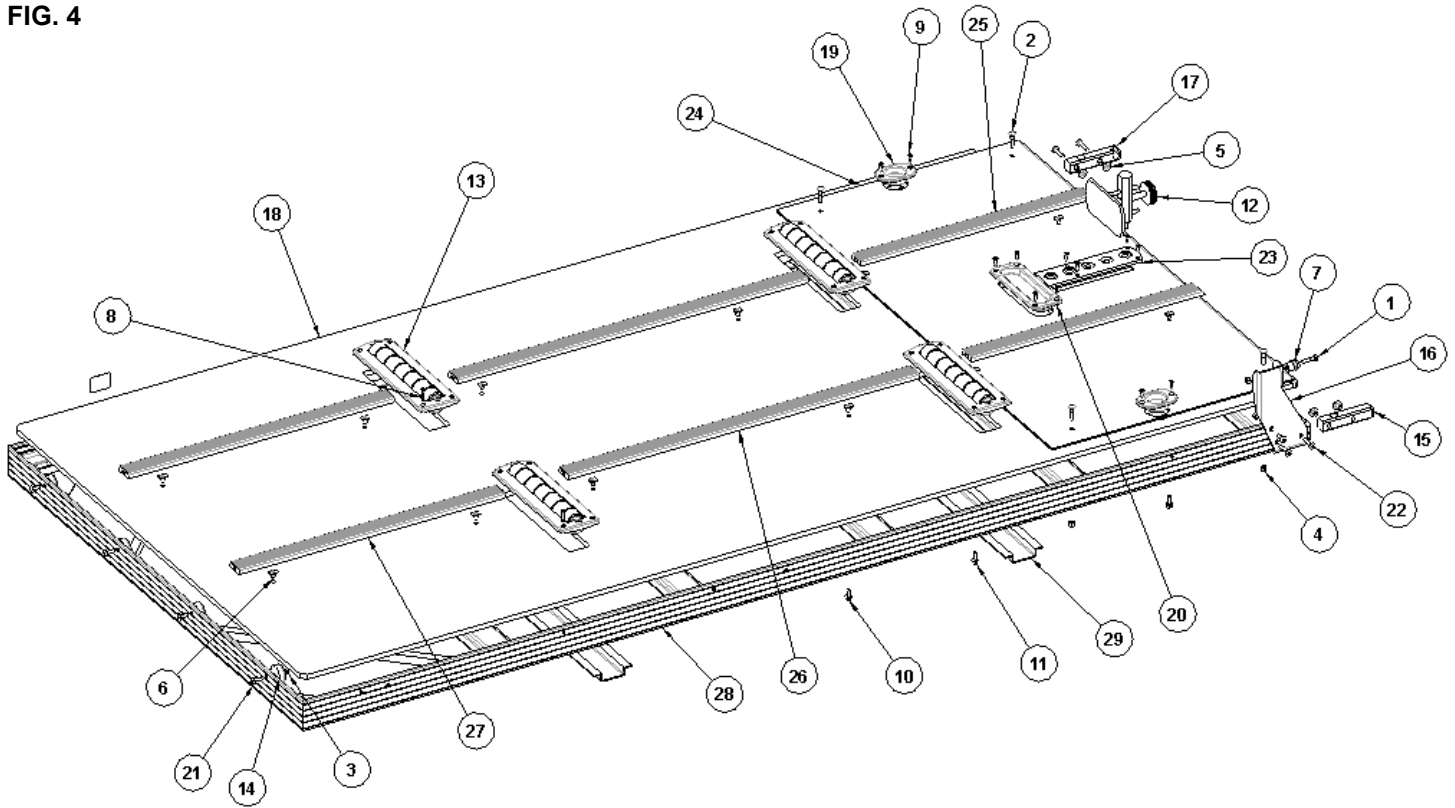

**PARTS LIST FOR SS150 XL SINGLE DECK (7135X005)**

ITEM	DESCRIPTION	QTY	ITEM	DESCRIPTION	QTY
1	1/4 X 1 1/4 UNC HEX CAP SCR (GR 5)	1	16	BRACKET-STOP, RAMP	1
2	1/4 X 1 1/4 UNC RND HD SQ BOLT	4	17	TUBE-MOUNT, RAMP	1
3	1/4 UNC HEX NUT (GR B)	4	18	DECK BOARD	1
4	1/4 UNC HEX NYLOCK NUT (GR B)	6	19	RECESSED COT CUP	2
5	NUT 1/4-20 X 7/16 HT PROPELLER TEE	4	20	SUPER SIZED RECESSED COT CUP	1
6	1/4-20 X 7/16 SLAB BASE WELD NUT	12	21	1/4 X 3/4 UNC TRUSS HD PH MACH SCR	5
7	RAMP HOLDER, MALE END	1	22	1/4 X 1 1/4 UNC TRUSS HD PH MACH SCR	4
8	#10 X 1 SS FLAT HD TYPE B TAP SCR	16	23	BIER PIN PLATE (5 HOLE)	1
9	#10 X 3/4 SS FLAT HD TAP SCR	12	24	REAR ANGLE GUARD	1
10	1/4 X 5/8 FLANGE HEAD BOLT	8	25	GLIDE STRIP	2
11	1/4 X 3/4 FLANGE HEAD BOLT	4	26	GLIDE STRIP	2
12	BIER PIN-ADJUSTABLE	1	27	GLIDE STRIP	2
13	CR60 CASKET ROLLER	4	28	DECK WELDMENT	1
14	BUMPER-RECESSED, 1.50 O.D. X .63 H	4	29	FLOOR SPLICE	2
15	TUBE-MOUNT, RAMP	1	-	-	-

## PARTS LIST FOR SS150 CARGO VAN HARDWARE KIT (71353002)

ITEM	DESCRIPTION	QTY
1	1/4 X 3/4 UNC HEX CAP SCR	2
2	3/8 UNC HEX JAM NUT	2
3	3/8 UNC HEX NYLOCK NUT	2
4	3/8 TYPE A PLAIN WASHER	4
5	3/8 X 3 SS STUD	2
6	KNOB-CLAMPING, 1 3/4 X 1, 3/8 UNC THRU	2
7	PLASTIC KNOB W/ THREADED INSERT 1/4-20	2
8	BRACKET-HOLD DOWN, DECK	2

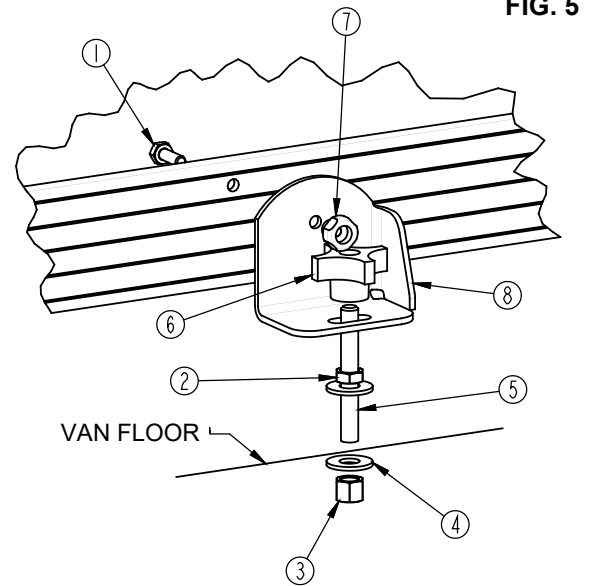
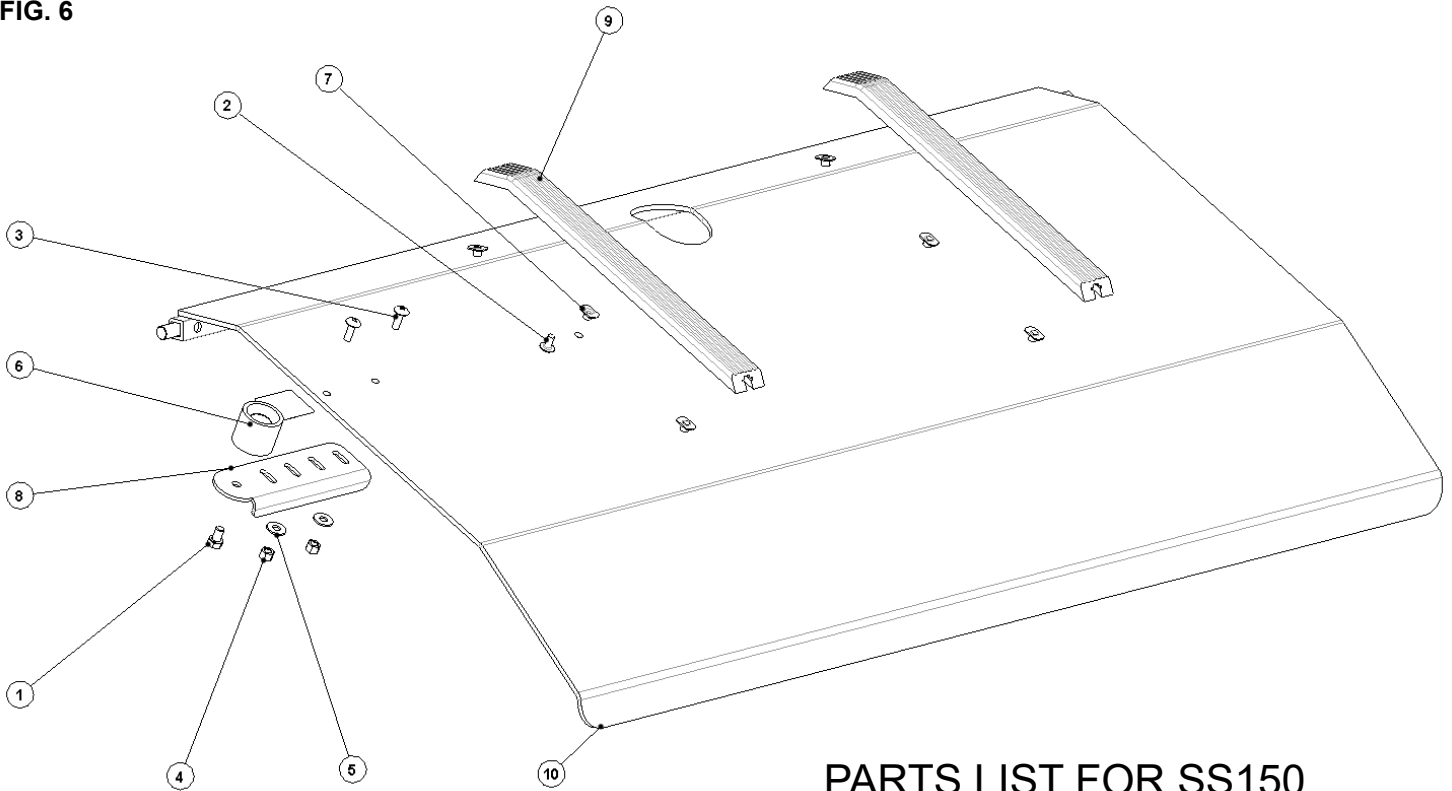

FIG. 5

FIG. 6



## PARTS LIST FOR SS150 CHEVY RAMP KIT (71352109)

ITEM	DESCRIPTION	QTY
1	5/16 X 1/2 UNC HEX CAP SCR	1
2	1/4 X 1/2 UNC TRUSS HD PH MACH SCR	6
3	1/4 X 3/4 UNC TRUSS HD PH MACH SCR	2
4	1/4 UNC HEX NYLOCK NUT	2
5	1/4 TYPE A PLAIN WASHER	2
6	RAMP HOLDER, FEMALE END	1
7	1/4-20 X 1/4 SLAB BASE WELD NUT	6
8	BRACKET-STOP, RAMP	1
9	GLIDE STRIP	2
10	RAMP WELDMENT	1

FIG. 7

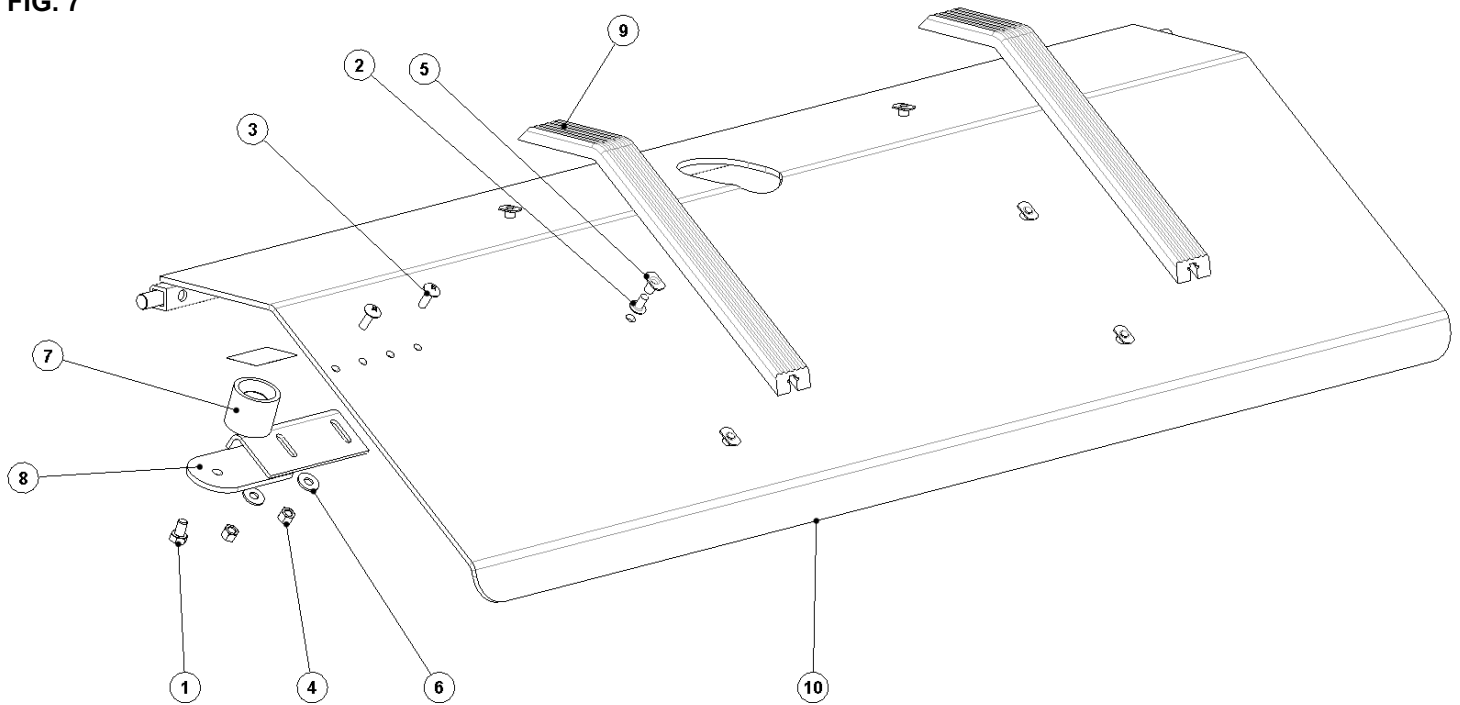

PARTS LIST FOR SS150  
FORD CARGO AND DODGE RAM CARGO RAMP KIT

ITEM	DESCRIPTION	QTY
1	5/16 X 1/2 UNC HEX CAP SCR	1
2	1/4 X 1/2 UNC TRUSS HD PH MACH SCR	6
3	1/4 X 3/4 UNC TRUSS HD PH MACH SCR	2
4	1/4 UNC HEX NYLOCK NUT	2
5	1/4-20 X 7/16 SLAB BASE WELD NUT	6
6	1/4 TYPE A PLAIN WASHER	2
7	RAMP HOLDER, FEMALE END	1
8	BRACKET-RAMP, STOP	1
9	GLIDE STRIP	2
10	RAMP WELDMENT	1

## ***SPECIFICATIONS for SS150 Single Deck for Cargo Vans***

<b>DECK CAPACITY:</b>		
Maximum Load Length with Ramp Installed	.....	<b>92.5"</b>
Maximum Load Length without Ramp Installed	.....	<b>96.0"</b>
Maximum Load Width	.....	<b>47.5"</b>
<b>VEHICLE REQUIREMENTS:</b>		
Overall Deck Length (With Ramp up)	.....	<b>96.0"</b>
Overall Deck Width	.....	<b>48.0"</b>
<b>WEIGHT OF DECK</b> (including ramp)	.....	<b>135 lbs.</b>
<b>APPROXIMATE HEIGHT OF DECK FROM GROUND*</b>	.....	<b>32 "</b>
<b>ADJUSTABLE BIER PIN AVAILABLE</b>	.....	<b>Standard</b>
<b>REAR WEAR PLATE</b>	.....	<b>Yes</b>
<b>REMOVABLE RAMP</b>	.....	<b>Yes</b>
<b>TIE DOWN METHOD</b>	.....	<b>Supplied Brackets Mount to Floor</b>
<b>INSTALLATION TIME</b>	.....	<b>30 minutes</b>
<b>WARRANTY</b>	.....	<b>1 Year</b>

\*Height may vary depending on vehicle.

