

**LINK[®] MORTUARY
EQUIPMENT**

INSTALLATION INSTRUCTIONS

HEARSE DECK HD150 (7134B001)



The **Link HD150** fits most hearses.

Estimated weight : 60 lbs.

Link Mortuary Equipment, a division of Link Mfg., Ltd.
www.linkmortuaryequipment.com

223 15th St. N.E.
Sioux Center, IA USA
51250-2120
www.linkmortuaryequipment.com

**QUESTIONS?
CALL CUSTOMER
SERVICE
1-800-248-3057**

71340013
JULY 28, 2023

1. INTRODUCTION

Thank you for choosing a Link Mortuary Equipment HD150. We want to help you to get the best results from the deck and to operate it safely. This manual contains information to introduce you to the Link HD150 and to assist you with its installation. The manual is intended solely for use with this product.

All information in this manual is based on the latest information available at the time of printing. Link Manufacturing reserves the right to change its products or manuals at any time without notice. Contact Link Mortuary Equipment at (800) 248-3057 for information on recent changes to products.

Damaged components should be returned to Link with a pre-arranged Returned Goods Authorization (RGA) number through the Customer Service Department. The damaged component may then be replaced if in compliance with warranty conditions.

Review the **Parts List** below to become familiar with the different components of the **HD150**.

Installation:

- A.** The HD150 sits in the hearse and is secured in place by inserting the supplied pin (either Ø1/2" or Ø3/8" depending on the style of bier pin in the hearse) with the knob through the bier pin plate of the HD150 into the bier pin plate of the hearse. The position of the deck will vary depending on which holes are used. It is usually best to keep the deck as far back as possible while still being able to get the door closed.
- B.** A pair of Cot Post Tips has been included to replace the worn or missing tips from your cot. They will help keep the sharp edges of the cot legs from damaging the surface of the HD150. To install these tips, simply remove the old tips, insert the new tips, and lock them in place by tightening the screw on the bottom of the tip.

Maintenance:

- A.** Clean with soap and water.
- B.** Call Link Mfg. at 1-800-248-3057 with any questions or comments.

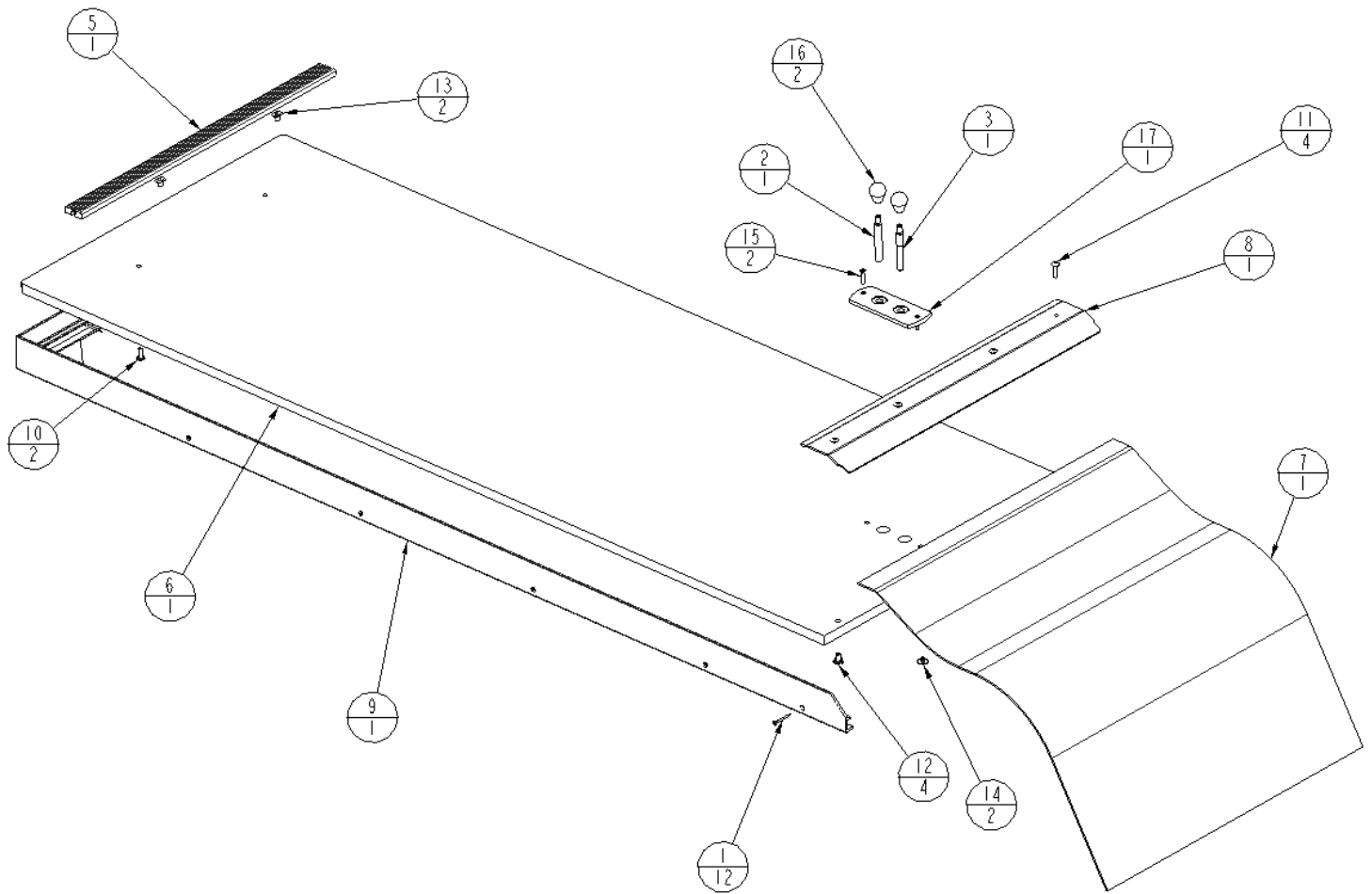

LINK® MODEL "HD150" PARTS LIST

ITEM	PART #	DESCRIPTION	QTY	ITEM	PART #	DESCRIPTION	QTY
1	15060011	SCREW-DRYWALL, 1 5/8"	12	11	144C0808	1/4 X 1 UNC TRUSS HD PH MACH SCR, SS	4
2	70000052	PIN-.50 X 3.00	1	12	14840800	1/4-20 X 9/16 TEE NUT W/PRONGS	4
3	70000053	PIN-.375 X 3.00	1	13	14840808	1/4-20 X 7/16 SLAB BASE WELD NUT	2
4	71340013	INSTRUCTIONS-INSTALLATION, HD150	1	14	14840P05	10-24 X 9/32 WELD IN T-NUT	2
5	71340021	STRIP-COT RESTRAINT	1	15	15060053	#10 -24 X 1.00, PHIL FLAT HEAD M.S. SS	2
6	71340026	BOARD-DECK, HD150	1	16	15070202	PLASTIC OVAL LEVER KNOB	2
7	71340028	MAT-BUMPER PROTECTION, HD150	1	17	15070289	BIER PIN PLATE	1
8	71340029	ANGLE GUARD-REAR, HD150	1	-	15001150	TUBE-2.00 X 12.00, SNAP SEAL	1
9	71341101	FRAME-HEARSE DECK	1	-	78000012	CPT-20	2
10	144C0806	1/4 X 3/4 UNC TRUSS HD PH MACH SCR, SS	2	-	15001708	TUBING-POLY, CLEAR, 3 MIL, BULK, 36	8



223 15TH ST. NE, SIOUX CENTER, IA 51250
1-800-248-3057
www.linkmortuaryequipment.com